



## Free 6'x10' Chicken Coop Plan

Up to 8 chickens

# Free vs. Premium Plan: What's the Difference?

We offer both free and premium versions of our detailed shed plans, designed to fit your needs and budget. Check out the table below to see the key differences and choose the plan that's right for you:

Features	Free Plan	Premium Plan
Metric measurements	X	✓
Illustrations per Step	Limited	Every Step
Print Ready Format	X	✓
Step-by-Step Instructions	Basic	Comprehensive
Full Materials & Cutting List	X	✓
Additional Illustrations	X	✓
Additional Blueprints	X	✓
Tools List	X	✓
Fastening Elements List	X	✓
Technical Support	X	✓

[Try Premium Risk-Free](#)

30-day refund policy with no questions asked.

## 6' x 10' chicken coop shopping list

Material	Unit	Qty	Size
Lumber (1 x 6)	pcs	4	12'
Lumber (1 x 6)	pcs	3	8'
Lumber (2 x 2)	pcs	10	6'
Lumber (2 x 4)	pcs	21	6'
Lumber (2 x 4)	pcs	17	8'
Lumber (2 x 4)	pcs	5	10'
Lumber (2 x 6)	pcs	9	8'
Lumber (4 x 4)	pcs	6	8'
Plywood siding (11/32")	pcs	6	4' x 8'
OSB (1/2")	pcs	6	4' x 8'

# Size & Dimensions

front

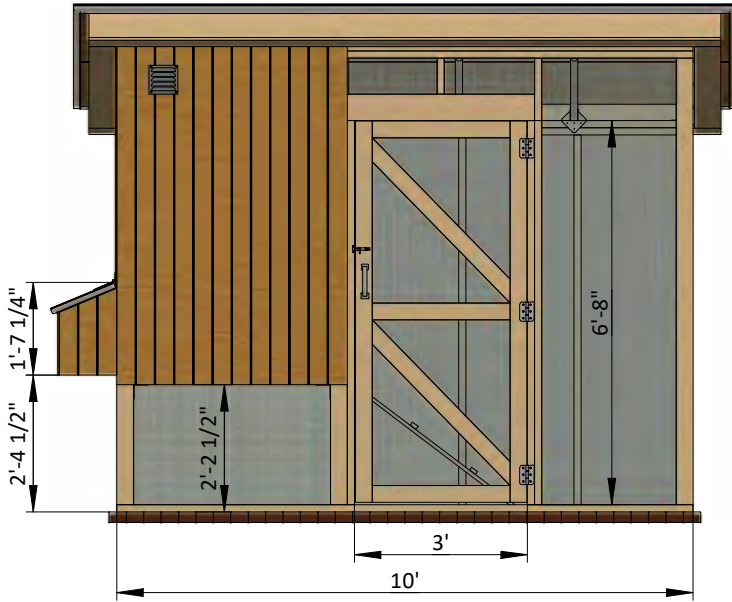

left

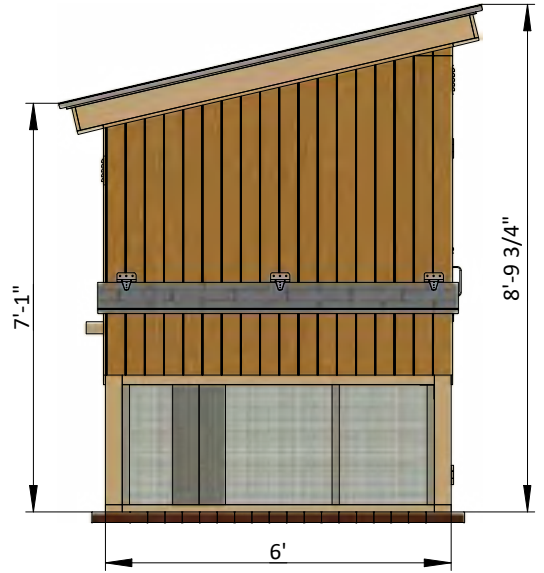

back

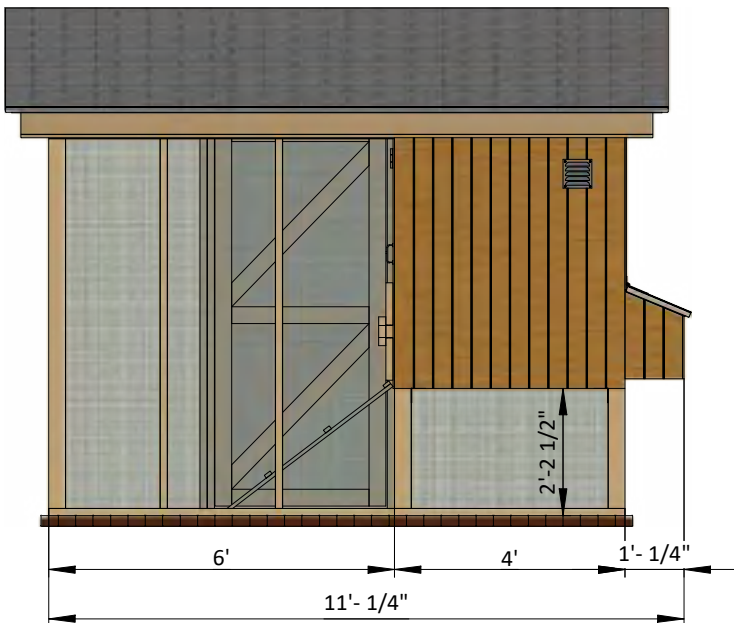

right

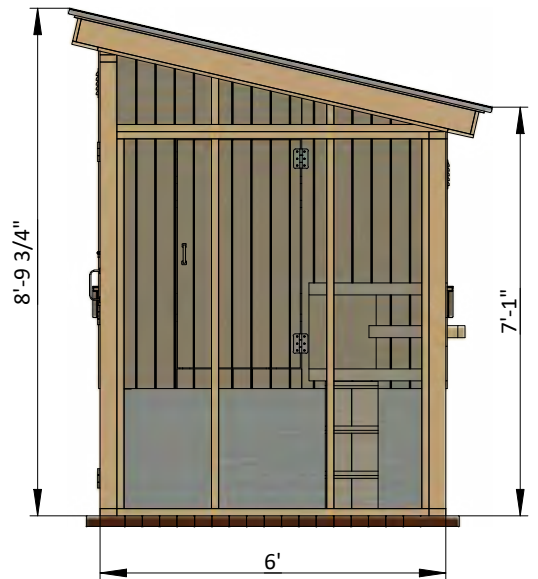

**Interior view**

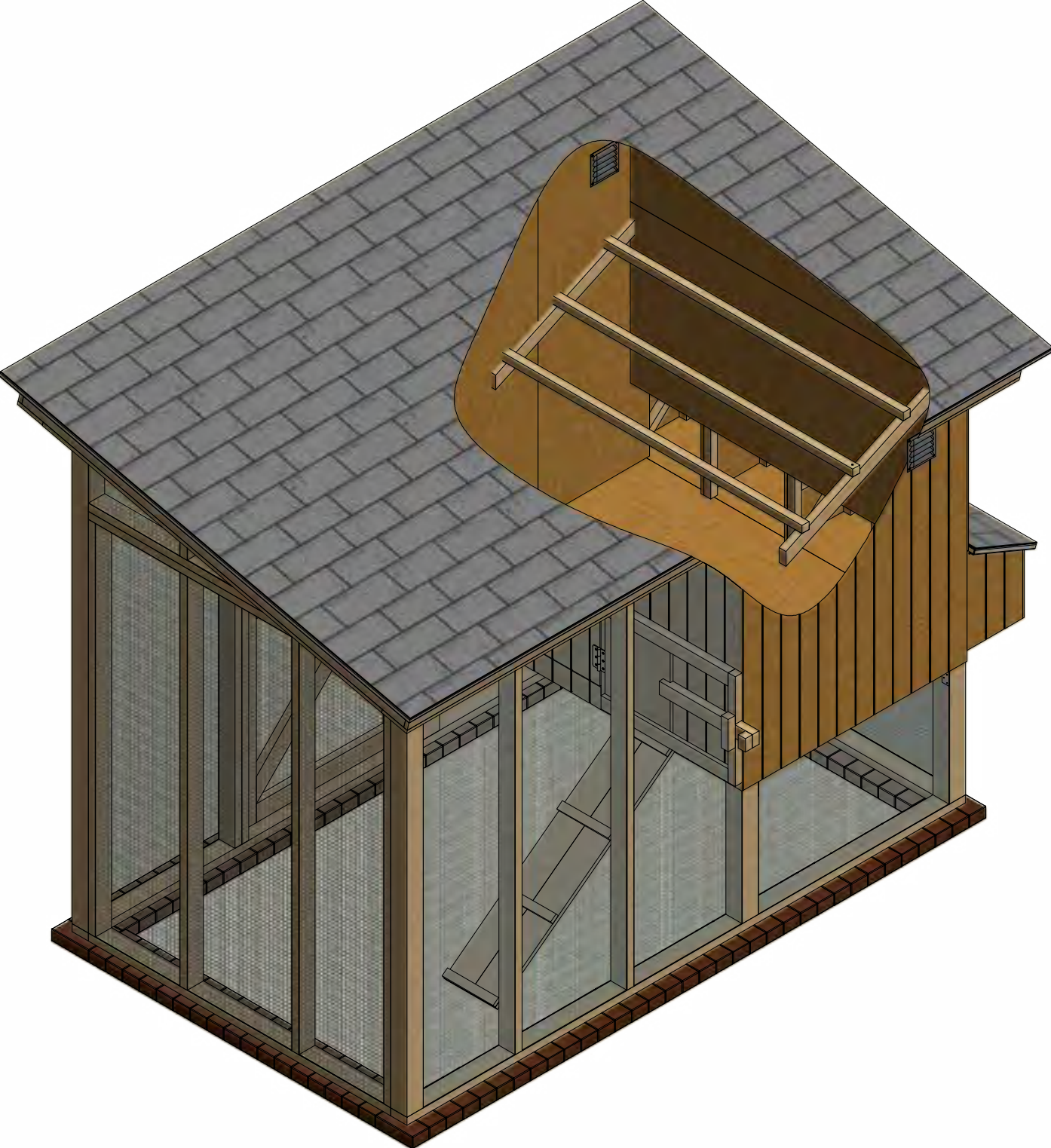

## STEP 1

### Foundation Preparation

**1.1** Fill the trenches to ground level with concrete and let cure, or harden. Since curing times vary between brands, read the packaging for recommended curing times.

**1.2** Once the concrete has cured, use standard-sized bricks and lay them across the foundation. You will need roughly 102 bricks for this step.

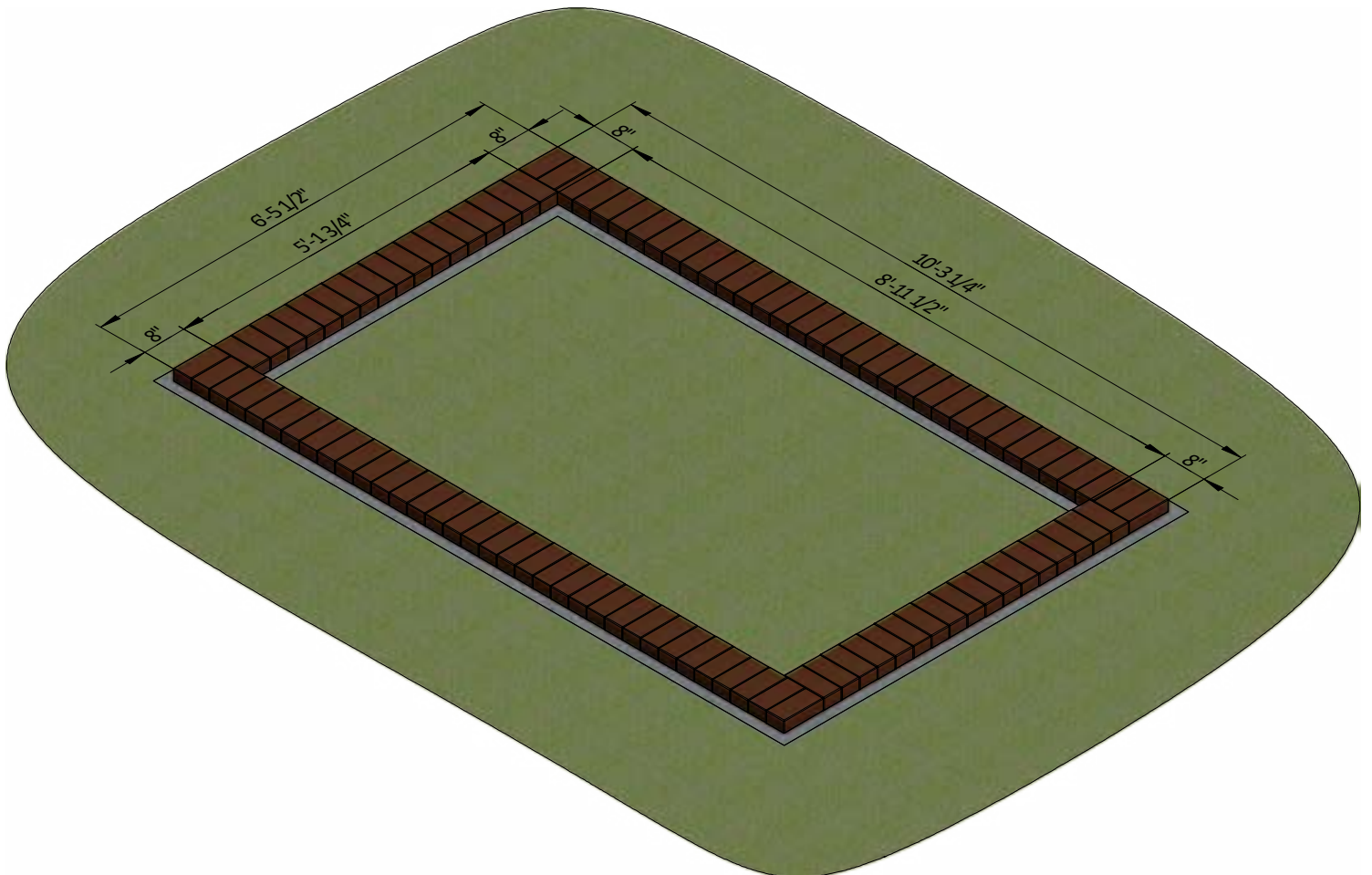
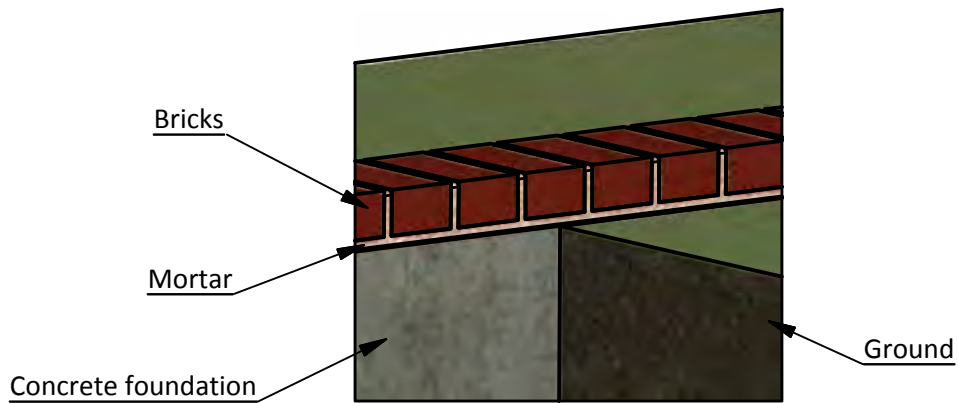

## STEP 2

### Assemble the Front Wall Frame

**2.1** Using 2x4, 2x6 and 4x4 lumber, construct front wall frame using the drawing below as a reference. You will need four boards cut to 7'-9" and two boards cut to 6'-8" that will be studs, two boards cut to 10' that will be the top and bottom beams, two boards cut to 3'-3" that will be the door header and one board cut to 7 1/2" that will be cripple stud.

**2.2** Connect the beams with 3" wood screws. Using a speed square or carpenter's square, check the corners to make sure they are 90°.

Pos	Description	Material	Dimension	Qty
A	Stud	4x4	7'-9"	3
B	Stud	2x4	7'-9"	1
C	Stud	2x4	6'-8"	2
D	Cripple stud	2x4	7 1/2"	1
E	Top beam/ Bottom beam	2x4	10'	2
F	Door header	2x6	3'-3"	2

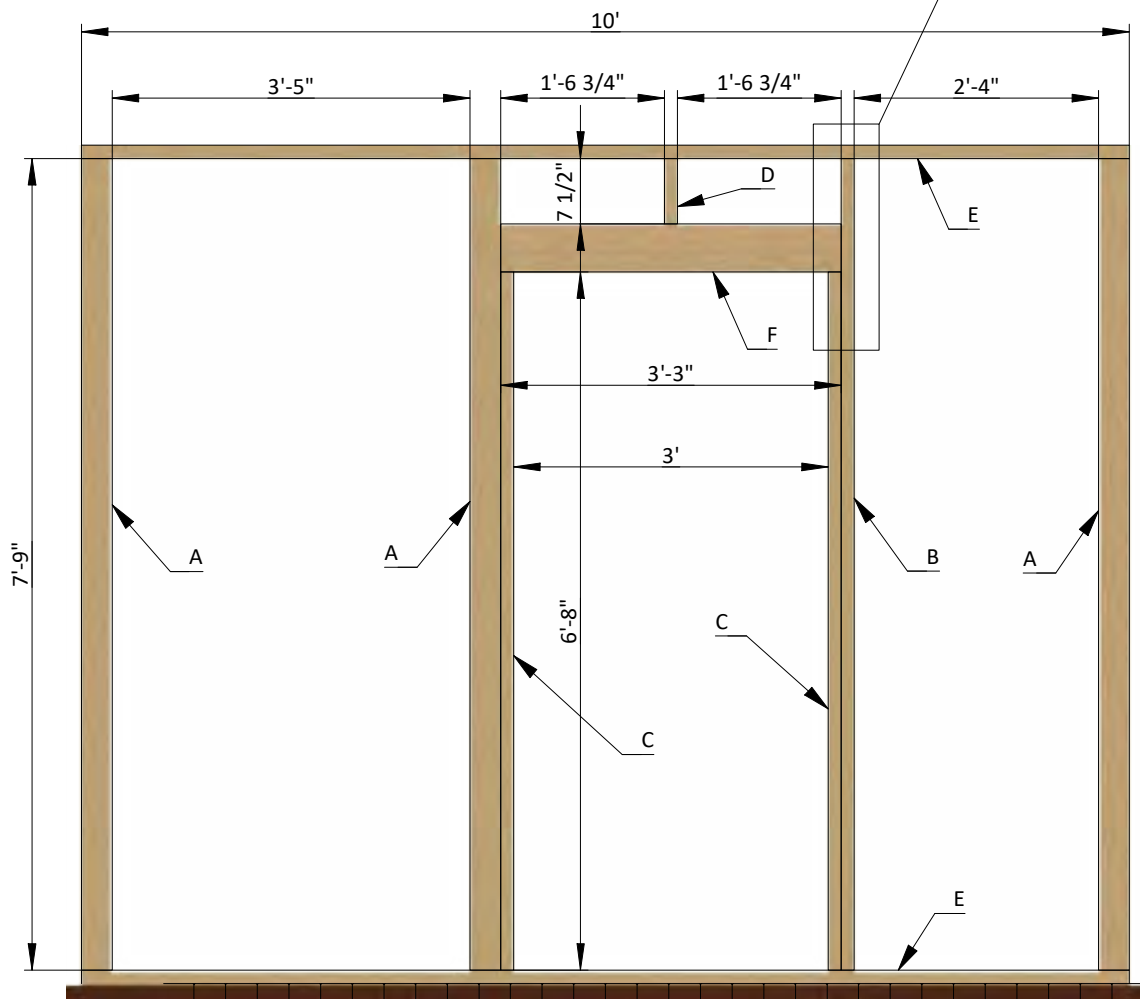
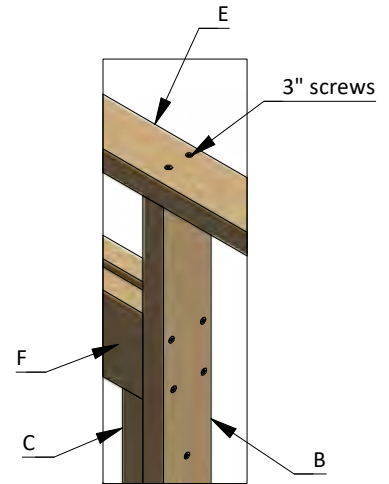

## STEP 3

### Assemble Back Wall Frame

**3.1** Using 2x4 and 4x4 lumber, construct the back wall frame using the drawing below as a reference. You will need five boards cut to 6'-5" that will be the studs and two boards cut to 10' that will be the top and bottom beams.

**3.2.** Connect the beams with 3" wood screws. Using a speed square or carpenter's square, check the corners to make sure they are 90°.

Pos	Description	Material	Dimension	Qty
A	Stud	4x4	6'-5"	3
B	Stud	2x4	6'-5"	2
C	Top beam/ Bottom beam	2x4	10'	2

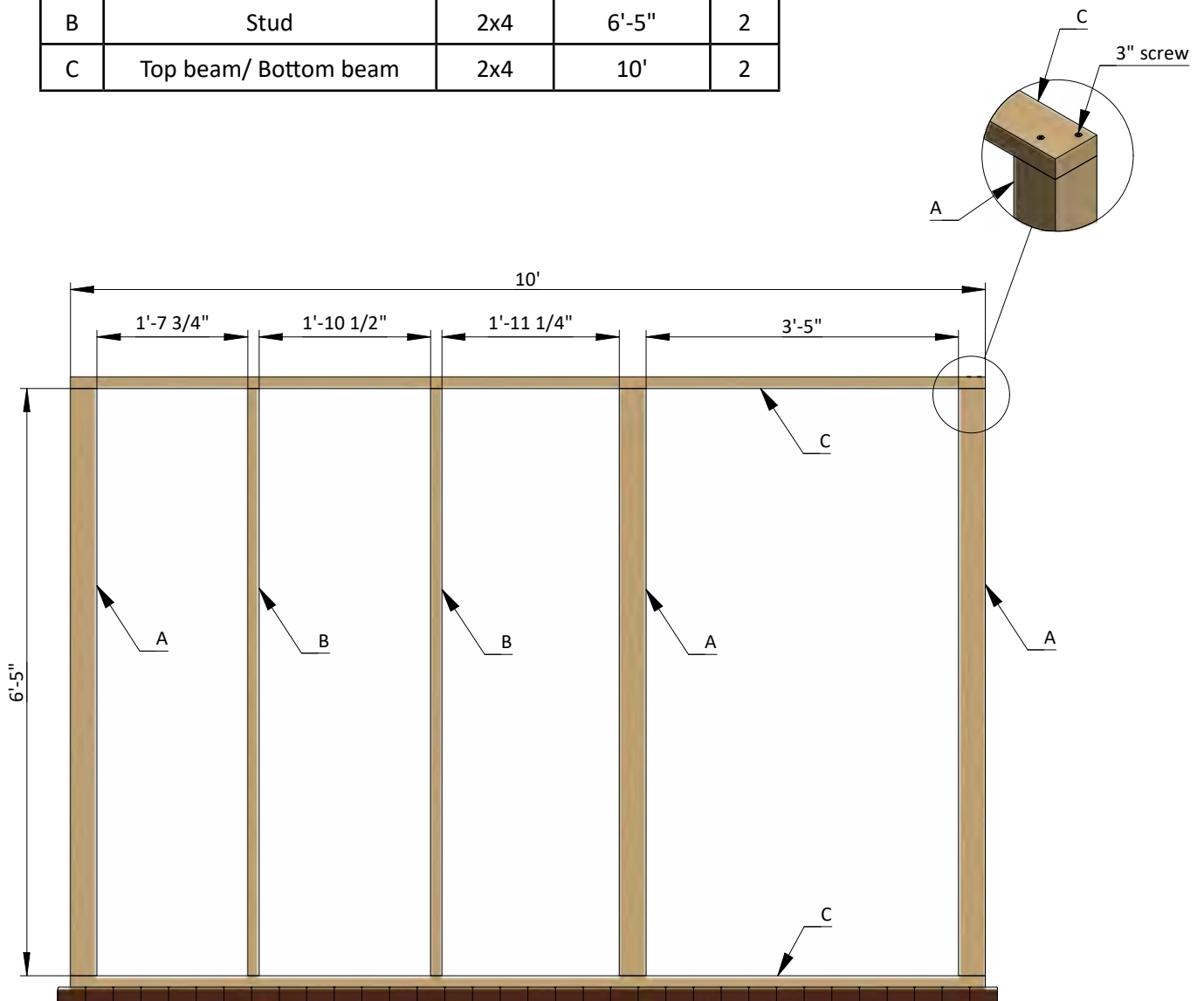

## STEP 4

### Assemble the Right Wall Frame

**4.1** Using 2x4 lumber, construct the right wall frame using the drawing below as a reference. You will need four boards cut to 6'-5" that will be studs and two boards cut to 5'-5" that will be the top and bottom beams.

**4.2** Connect the beams with 3" wood screws. Using a speed square or carpenter's square, check the corners to make sure they are 90°.

Pos	Description	Material	Dimension	Qty
A	Stud	2x4	6'-5"	4
B	Top beam/ Bottom beam	2x4	5'-5"	2

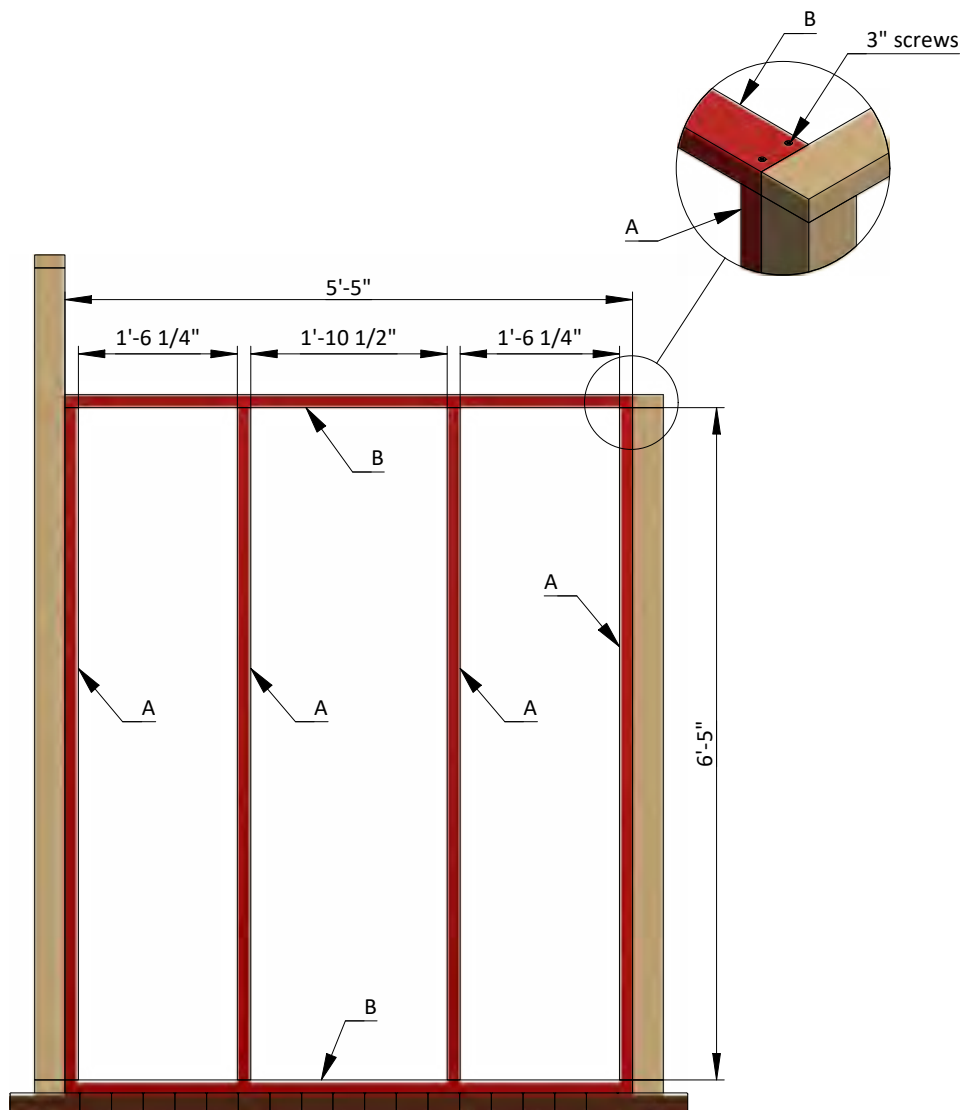

## STEP 5

### Assemble the Left Wall Frame

**5.1** Using 2x4 lumber, construct left wall frame using the drawing below as a reference.

You will need four boards cut to 2'-6 3/4" that will be studs and three boards cut to 5'-5" that will be the top and bottom beams.

**5.2** Connect the beams with 3" wood screws. Using a speed square or carpenter's square, check the corners to make sure they are 90°.

Pos	Description	Material	Dimension	Qty
A	Stud	2x4	2'-6 3/4"	4
B	Top beam/ Bottom beam	2x4	5'-5"	3

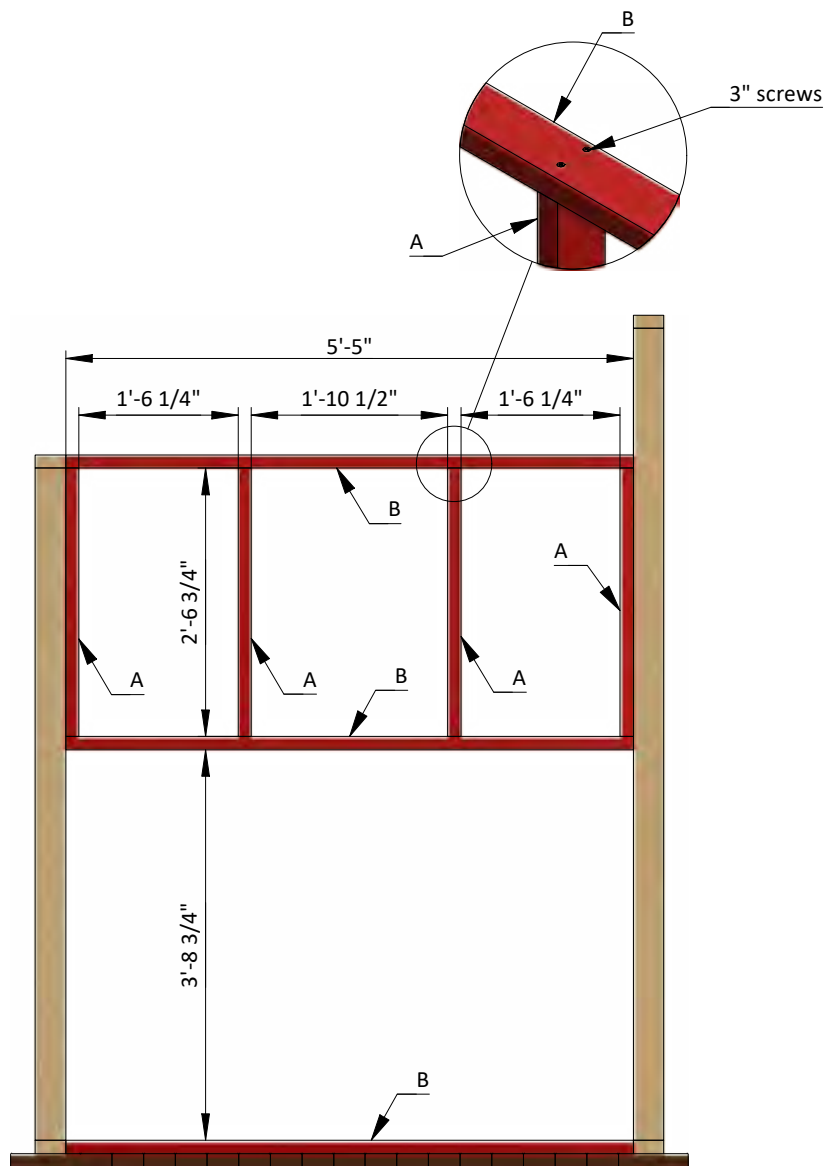

## STEP 6

### Assemble the Floor Frame

**6.1** Using 2x4 lumber, construct floor frame using the drawing below as a reference.

You will need two boards cut to 3'-5" and four boards cut to 3'-9" that will be joists and two boards cut to 5'-5" that will be rim joists.

**6.2** Connect the beams with 3"x3"x1 1/2" corner braces and 3" wood screws.

Using a speed square or carpenter's square, check the corners to make sure they are 90°.

Pos	Description	Material	Dimension	Qty
A	Joist	2x4	3'-5"	2
B	Joist	2x4	3'-9"	4
C	Rim joist	2x4	5'-5"	2

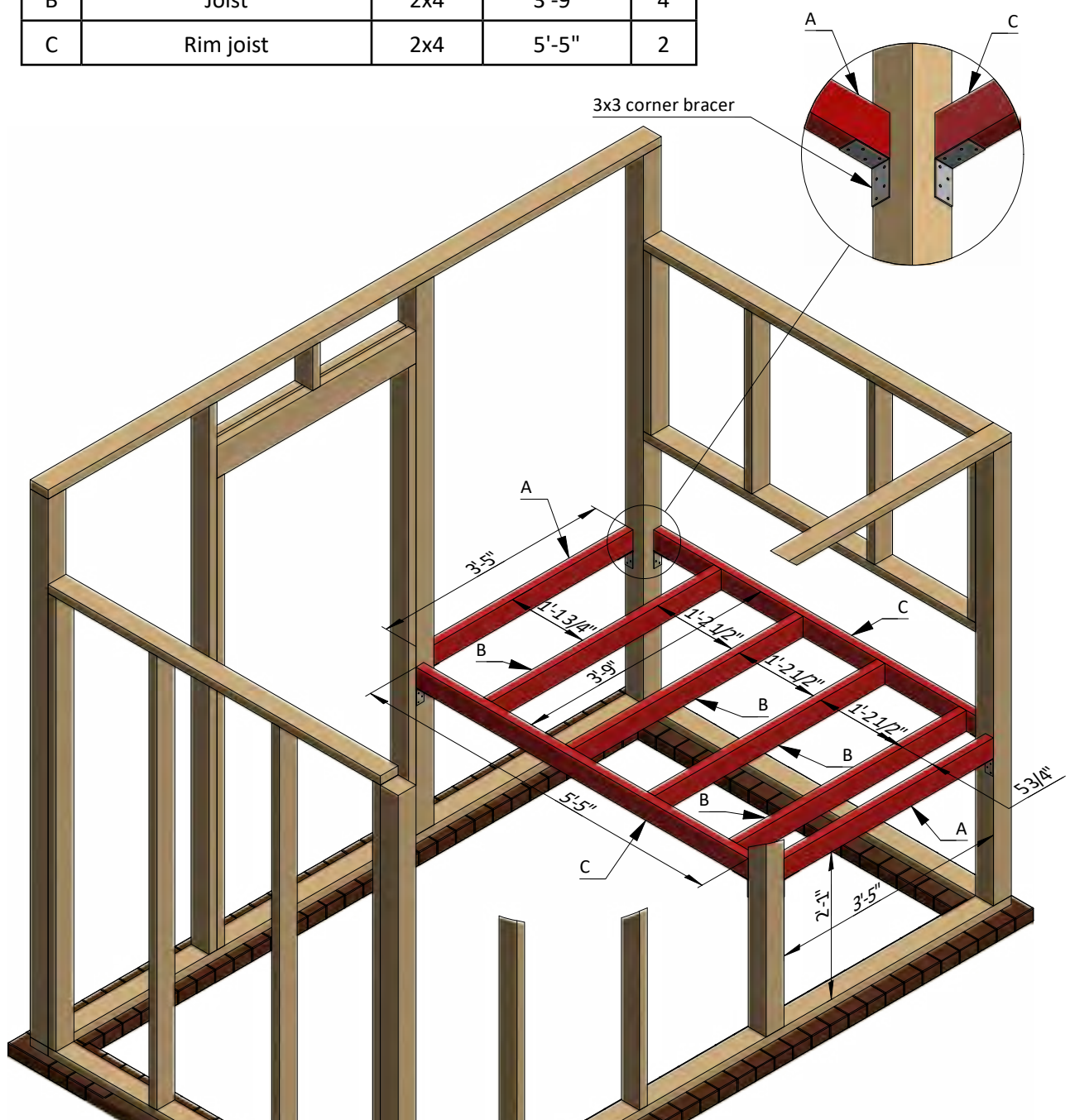

## STEP 7

### Nesting Box Frame Assembly

**7.1** Using 2x2 lumber, assemble the frame for the nesting box using the illustrations below as a guide. You will need two boards cut to 6' and three boards cut to 10 1/2" that will be front girts, two boards cut to 1'-1" and two boards cut to 10 1/2" that will be top girts, five boards cut to 10 1/2" that will be bottom girts.

**7.2** Make sure to provide slope for the lid of the nesting box.

Pos	Description	Material	Dimension	Qty
A	Joist	2x2	6'	2
B	Joist	2x2	10 1/2"	10
C	Rim joist	2x2	1'-1"	2

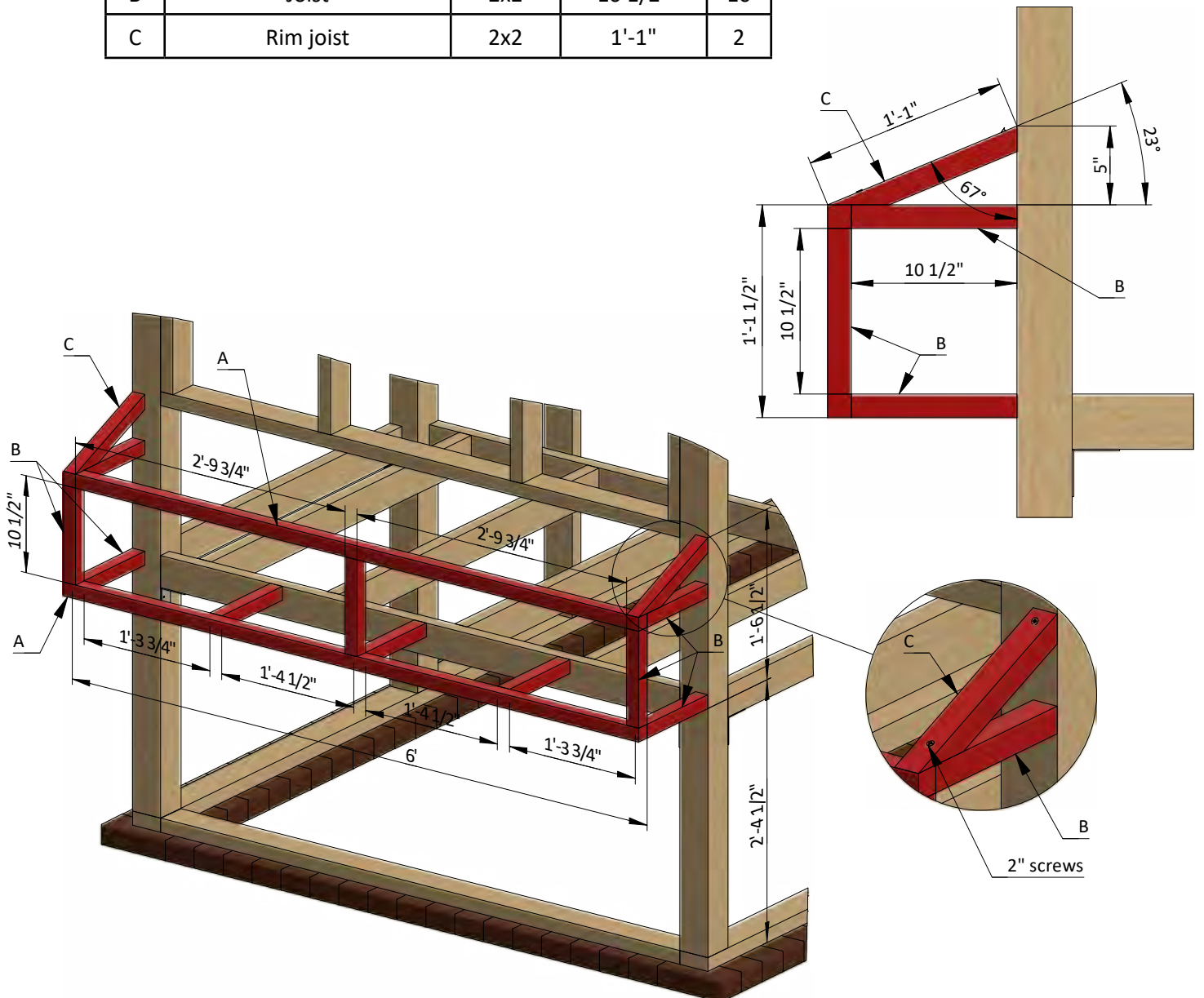

## STEP 8

### Install the Plywood Floor

**8.1** Prepare the 1/2" OSB for the floor sheathing according to the drawing. You will need one 3'-11 1/4" x 6' sheet and one 1'-3/4" x 6' sheet. Provide cuttings for connection with studs.

**8.2** Secure the plywood with 2" wood screws.

Pos	Description	Material	Dimension	Qty
A	Floor sheathing	1/2" OSB	3'-11 1/4" x 6'	1
B	Floor sheathing	1/2" OSB	1'-3/4" x 6'	1

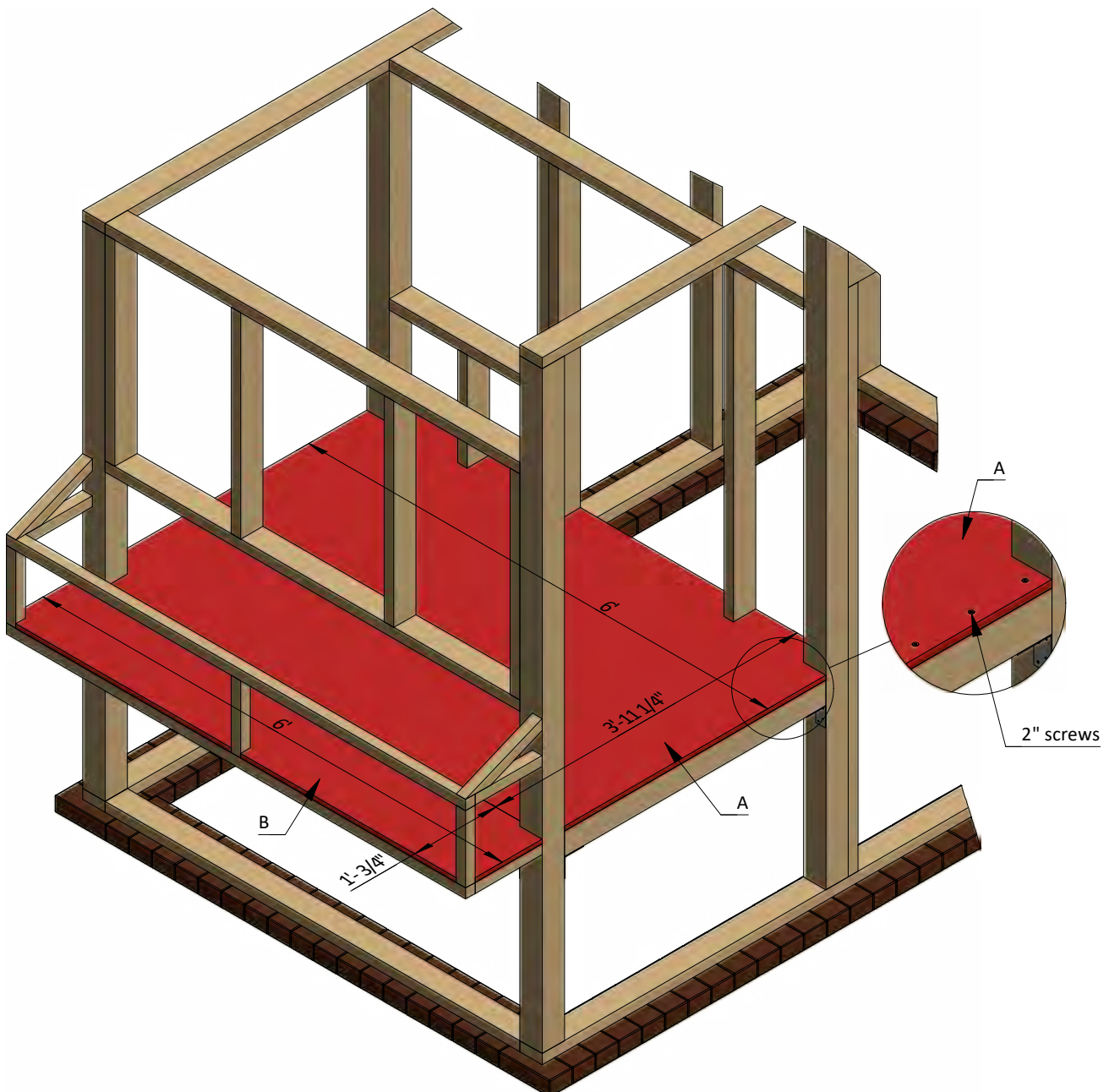

## STEP 9

### Assemble the Roof Frame

**9.1** Using 1x6 and 2x6 lumber, construct roof frame using the drawing below as a reference. You will need two boards cut to 7'-1/4" that will be rakeboards, six boards cut to 4 1/4" that will be outlookers and two boards cut to 10'-11 3/4" that will be fascias.

**9.2** Connect the beams with 2" and 3" wood screws.

**9.3** Using a speed square or carpenter's square, check the corners to make sure they are 90°.

Pos	Description	Material	Dimension	Qty
A	Rakeboard	2x6	7'-1/4"	2
B	Outlooker	2x6	4 1/4"	6
C	Fascia	1x6	10'-11 3/4"	2

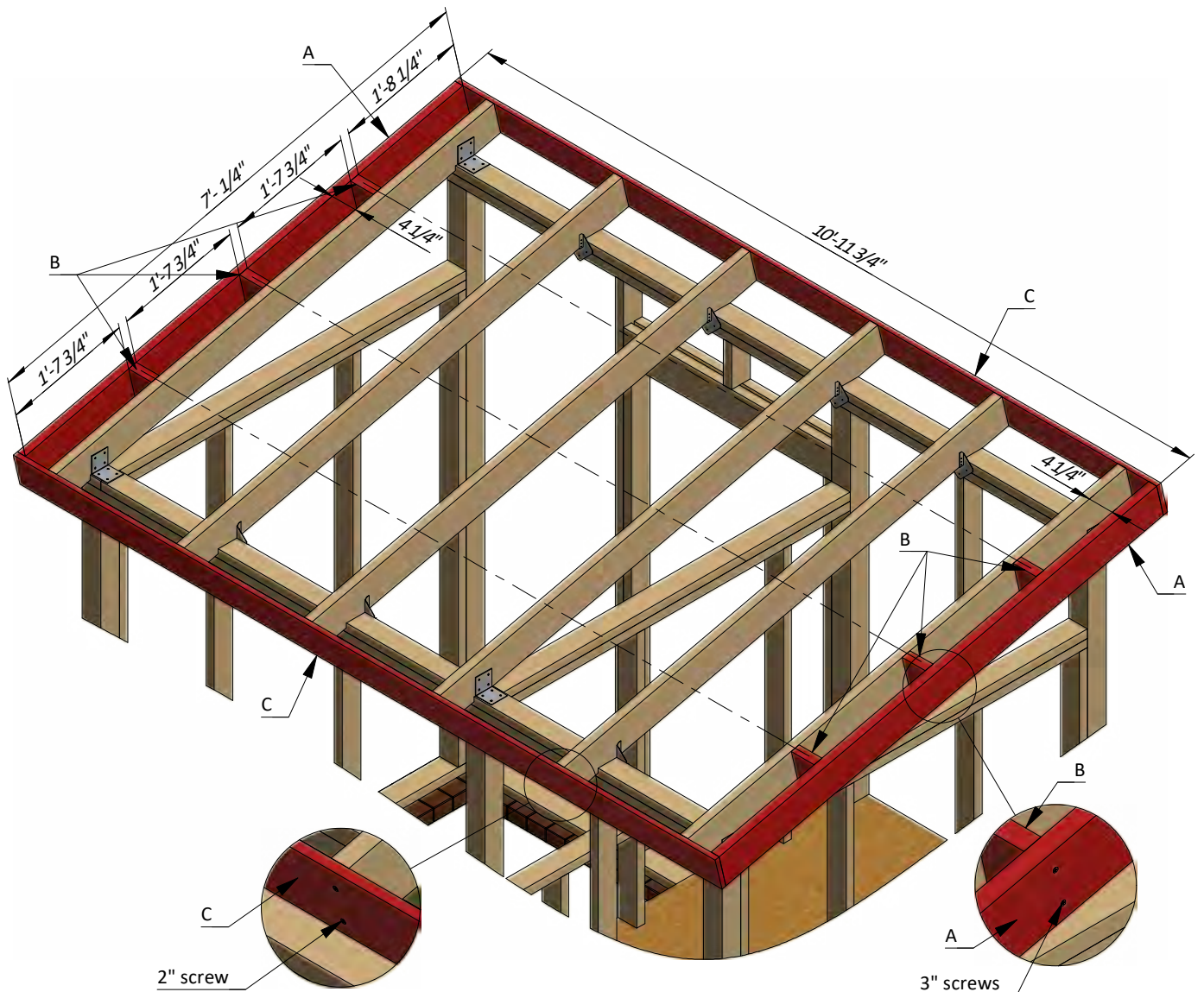

## STEP 10

### Assemble and Install Coop's Front Door

**10.1** Build the door frame using 2x4 lumber. You will need two boards cut to 3'-11 1/2" that will be the vertical girts, two boards cut to 1'-6 3/4" that will be the horizontal girts and one board cut to 3'-8 1/2" that will be the cross brace.

**10.2** Prepare the 11/32" plywood siding for outer sheathing.

You will need to cut one 2'-1 3/4" x 3'-11 1/2" sheet for the door according to the drawing.

**10.3** Install two 4" door hinges using 1" wood screws. Finish the door installation by attaching 6" door pull.

Pos	Description	Material	Dimension	Qty
A	Girt	2x4	3'-11 1/2"	2
B	Girt	2x4	1'-6 3/4"	2
C	Cross brace	2x4	3'-11 1/2"	1
D	Door sheathing	11/32" plywood	2'-1 3/4" x 3'-11 1/2"	1

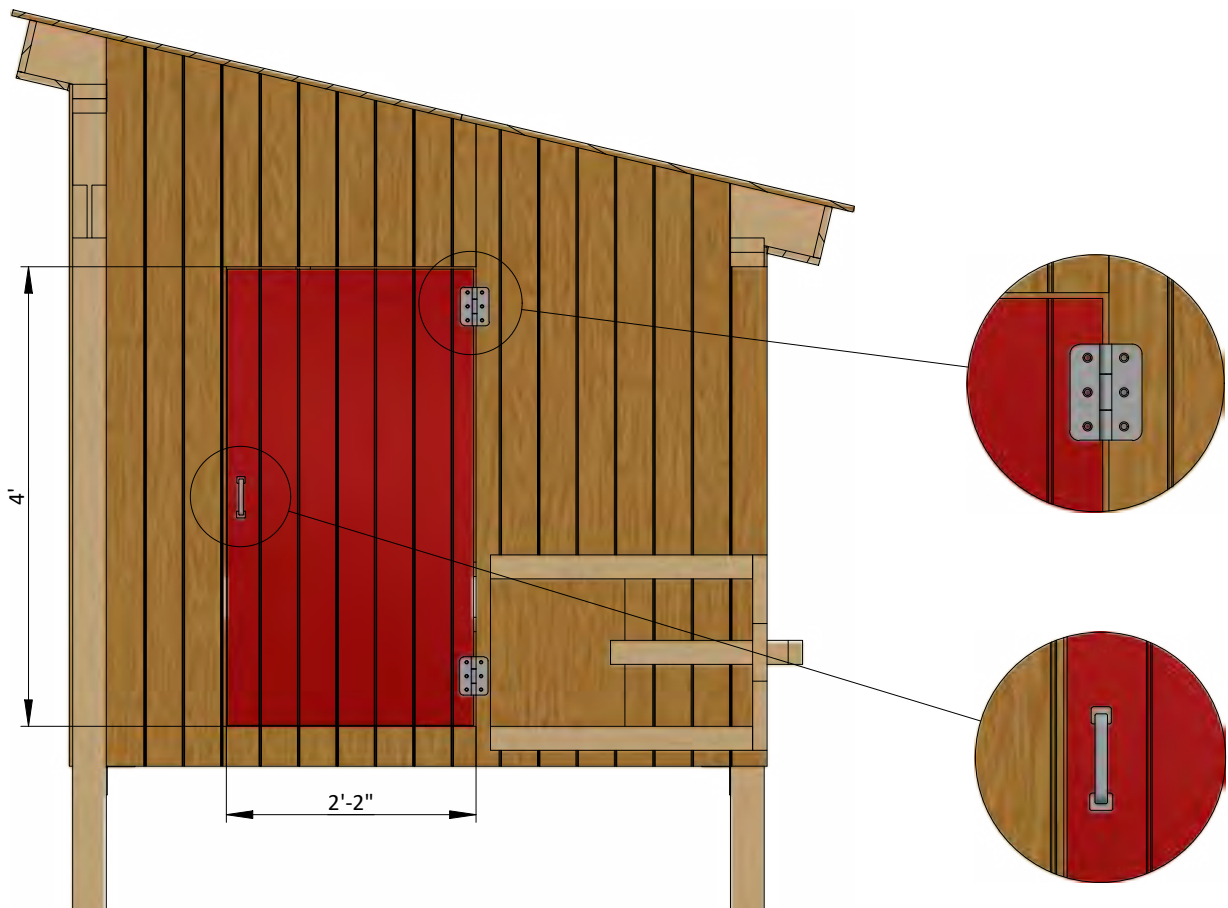

## STEP 11

# Coop's Roof Sheathing Installation

**11.1** Prepare metal drip edge with 6" width. You will need 40' to cover all the perimeter.

**11.2** Place the drip edge down, aligning it to the plywood edge. Use 2" nails to secure the first drip edge. When you place the next drip edge piece, it should overlap the first by an inch.

**11.3** You will need 87 Sq Ft of building paper and asphalt shingle roofing.

**11.4** Cover the plywood and drip edge with building paper. Try to install sheets with 1" overlapping. Use 2" nails to secure the sheets.

**11.5** Install asphalt shingle roofing using an industrial stapler.

Pos	Description	Material	Dimension	Qty
A	Metal drip edge	6"	-	40'
B	Roof sheathing	Building paper	-	87 square ft
C	Roof sheathing	Asphalt shingle roofing	-	87 square ft

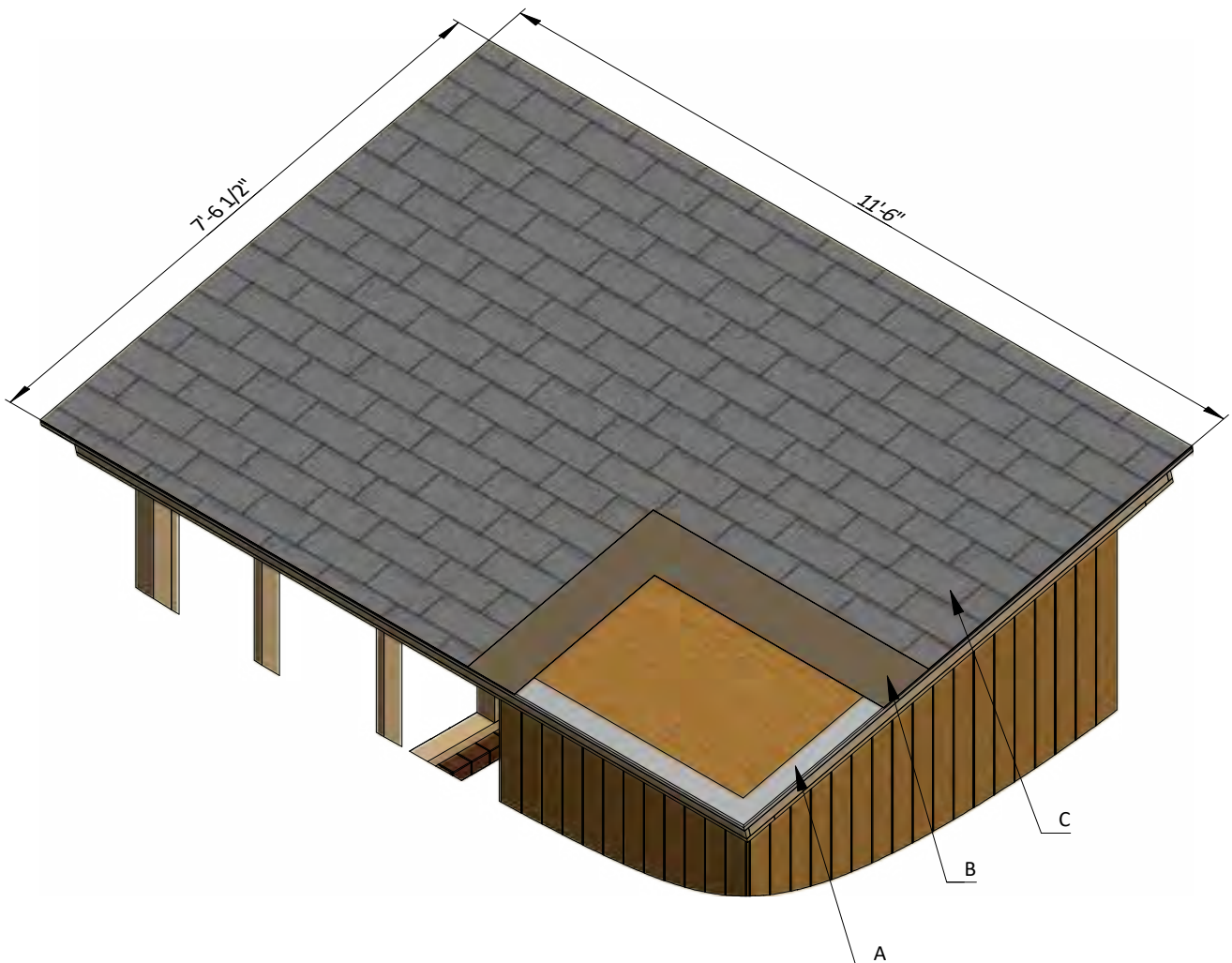

## STEP 12

### Installing the Nesting Box Lid

**12.1** Cut sheet of 1/2" OSB for the lid and inner partitions using the drawing below as a guide. You will need one 1'-2" x 6'-2 3/4" sheet for the lid and three 1'-1 1/2" x 1'-3 3/4" sheets for partitions.

**12.2** Prepare metal drip edge with 6" width. You will need 10' to cover all the outer edges.

**12.3** Place the drip edge down, aligning it to the plywood edge. Use 1/2" nails to secure the first drip edge. When you place the next drip edge piece, it should overlap the first by an inch.

**12.4** You will need 8 square ft of building paper and asphalt shingle roofing.

**12.5** Cover the plywood and drip edge with building paper. Try to install sheets with 1" overlapping.

**12.6** Install asphalt shingle roofing using an industrial stapler.

**12.7** Connect the lid to the front wall with the help of three 3" x 3" tee surface mount hinges.

Pos	Description	Material	Dimension	Qty
A	Lid sheathing	1/2" OSB	1'-2" x 6'-2 3/4"	1
B	Metal drip edge	6"	-	10'
C	Roof sheathing	Building paper	-	8 square ft
D	Roof sheathing	Asphalt shingle roofing	-	8 square ft
E	Partitions	1/2" OSB	1'-1 1/2" x 1'-3 3/4"	3

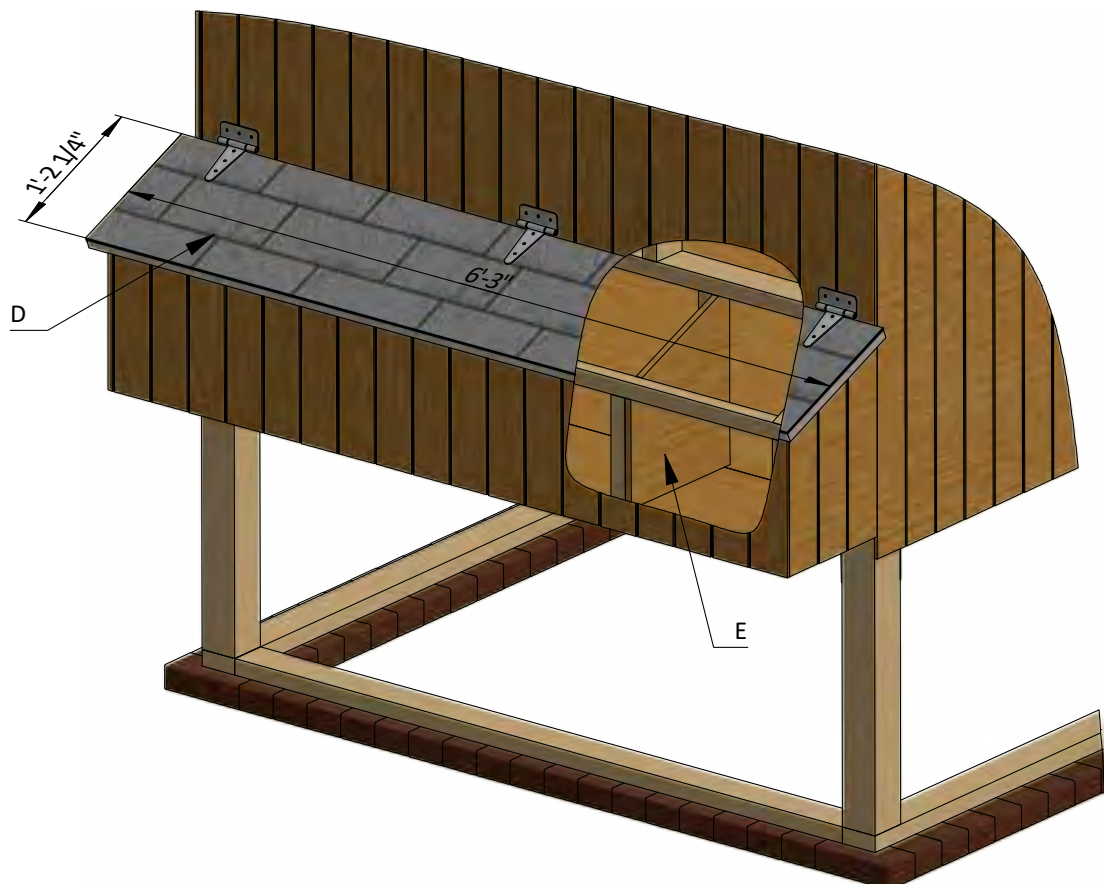

## STEP 13

# Mesh Wall Installation

13.1 Cover the walls with 1/4" wire mesh with the help of industrial stapler. You will need 130 sq ft.

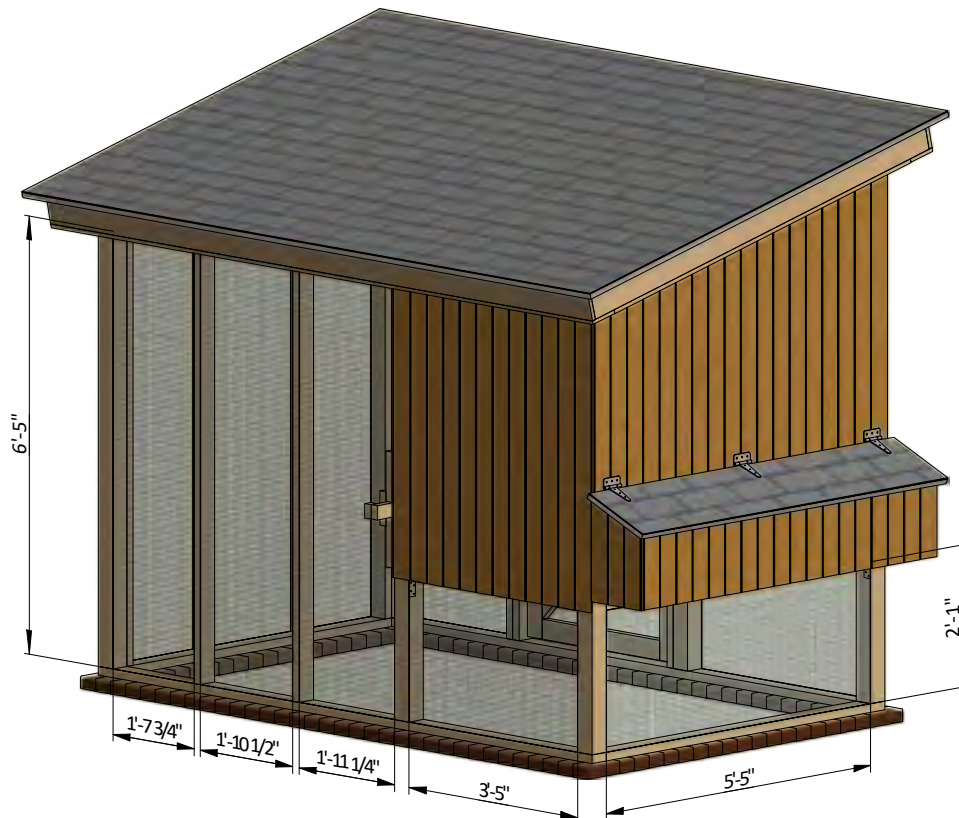
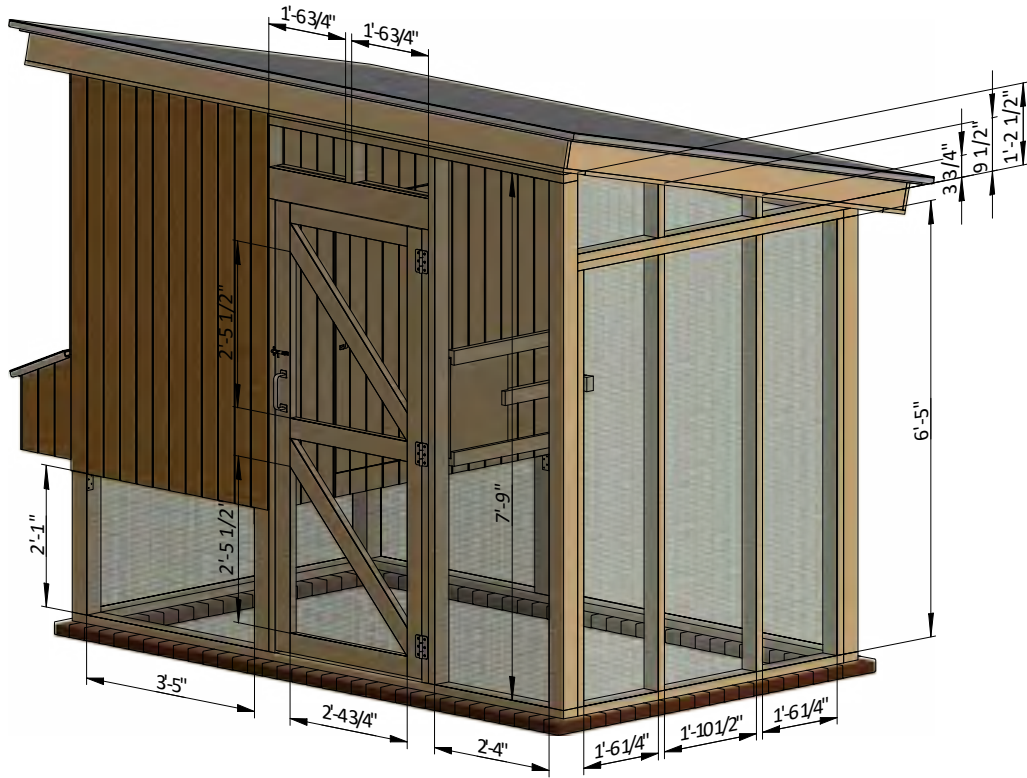

## STEP 14

### Assemble The Middle Roost

**14.1** Assemble the roost using 2x2 and 2x4 lumber. You will need three boards cut to 5'-5" and two boards cut to 3'.

**14.2** Connect the beams with 2" wood screws.

**14.3** Install the roost at the studs with the help of 3" screws.

Pos	Description	Material	Dimension	Qty
A	Girt	2x4	3'	2
B	Stair	2x2	5'-5"	3

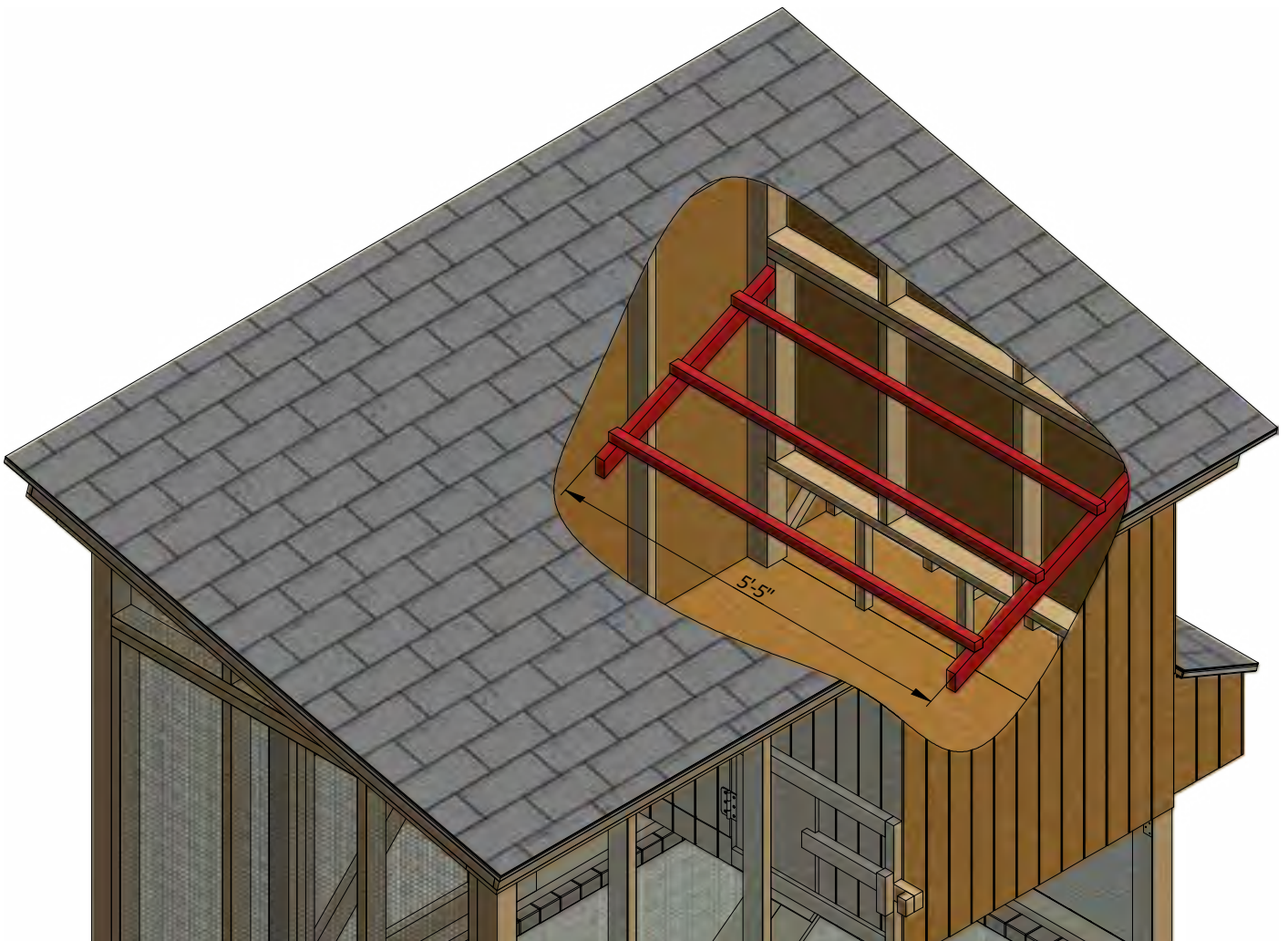

## STEP 15

### Final Touches

Now that your chicken coop is all done, you are ready to decorate it any way you want using your favorite paint, stain, or preservative.



# Free vs. Premium Plan: What's the Difference?

We offer both free and premium versions of our detailed shed plans, designed to fit your needs and budget. Check out the table below to see the key differences and choose the plan that's right for you:

Features	Free Plan	Premium Plan
Metric measurements	X	✓
Illustrations per Step	Limited	Every Step
Print Ready Format	X	✓
Step-by-Step Instructions	Basic	Comprehensive
Full Materials & Cutting List	X	✓
Additional Illustrations	X	✓
Additional Blueprints	X	✓
Tools List	X	✓
Fastening Elements List	X	✓
Technical Support	X	✓

[Try Premium Risk-Free](#)

30-day refund policy with no questions asked.



For more great **HOW-TO** plans please visit: <https://craft.camp>

## **Copyright**

The text and illustrations that appear here are the exclusive property of craft.camp and are protected by federal copyright laws. The duplication, sale or distribution of any portion of these plans without prior written consent from the original designer will be subject to the appropriate penalties for copyright infringement. Sharing this plan on the web is only permitted with an indicated original source: <https://craft.camp>