



Free 15' x 30' Chicken Coop Plan

Up to 50 chickens

Free vs. Premium Plan: What's the Difference?

We offer both free and premium versions of our detailed shed plans, designed to fit your needs and budget. Check out the table below to see the key differences and choose the plan that's right for you:

Features	Free Plan	Premium Plan
Steps Count	15	31
Illustrations per Step	Limited	Every Step
Print Ready Format	X	✓
Step-by-Step Instructions	Basic	Comprehensive
Full Materials & Cutting List	X	✓
Additional Illustrations	X	✓
Additional Blueprints	X	✓
Tools List	X	✓
Fastening Elements List	X	✓
Technical Support	X	✓

[Try Premium Risk-Free](#)

60-day refund policy with no questions asked.

30'x15' chicken coop material list

Site Preparation

- Concrete
- Bricks

Bottom Frame

- Pressure-Treated Lumber
- Plywood

Walls Frames

- Pressure-Treated Lumber

Shed's Roof

- Pressure-Treated Lumber
- Pressure-Treated Board
- Plywood
- Building paper
- Asphalt shingles
- Metal drip edge

Front/Side Shed's Window

- Pressure-Treated Lumber
- Window beading
- Glass

Walls Exterior Siding

- Pressure-Treated Lumber
- Wood siding boards

Top Frame

- Pressure-Treated Lumber

Fasteners & Hardware

- Corner braces
- Galvanized nails
- Wood screws

STEP 1

Assemble The Side Walls Frames

It is necessary to prepare 2 bottom plates, 2 top plates and 4 studs for 2 frames.

1.1 Use 3 1/2 " x 7 1/4 " material to create the bottom plates and use Node A as for your reference.

1.2 Use 3 1/2 " x 5 1/2 " material for the studs and bottom plates and use Nodes B, C, and D as a reference.

1.3 Secure with 3 " wood screws.

1.4 Secure beams with 3x3" wood screws.

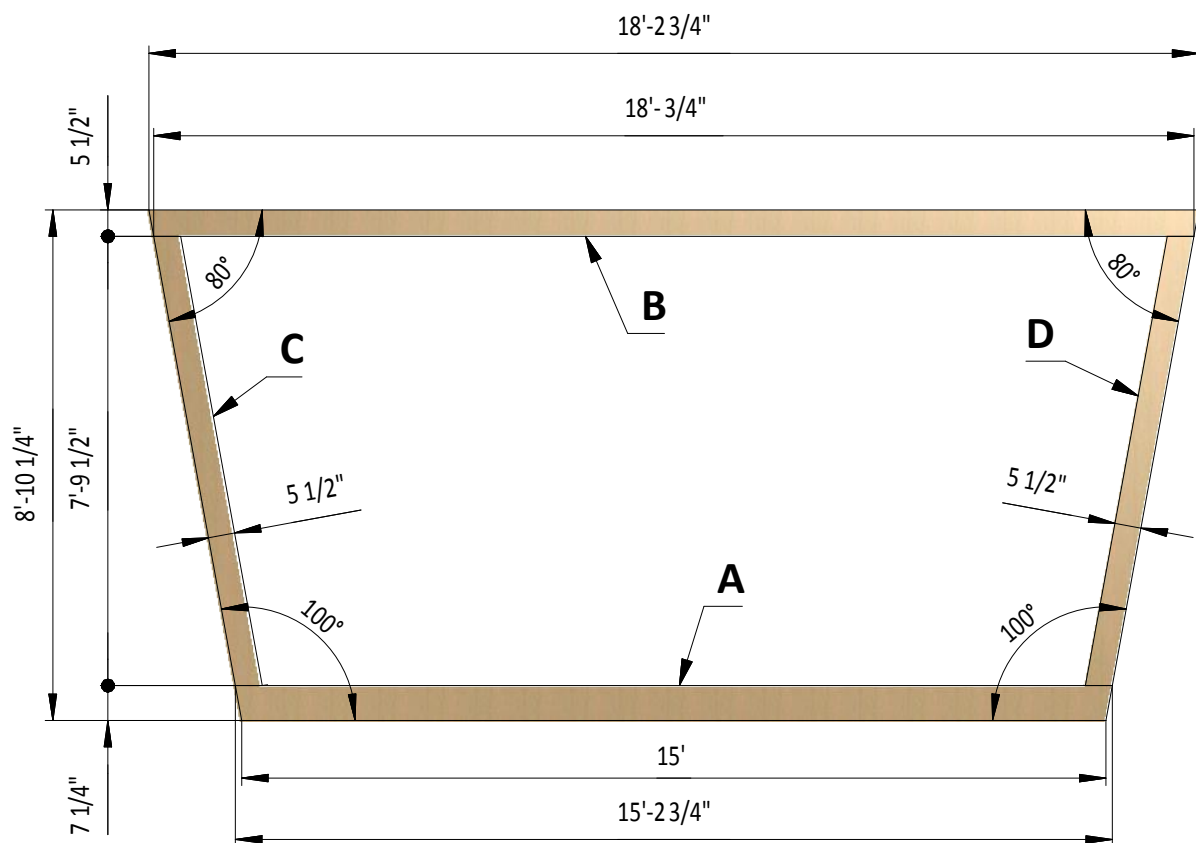

STEP 2

Assemble The Rafter Supports

2.1 Prepare two rafter supports with cross-section 3 1/2 x 5 1/2 inch.

2.2 For this step, you will need four corner braces that measure 1/2 " x 4 1/2 " x 1 1/2 " and two corner braces that measure 3" x 3" x 3". Use Node's E and F as a reference and secure with 2" wood screws to secure the braces.

E (1:10)

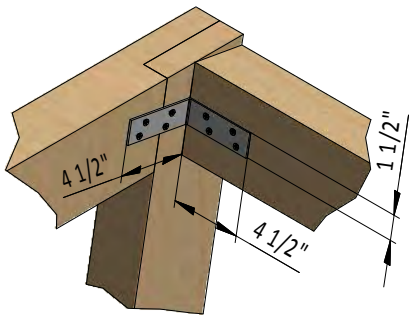

F (1:10)

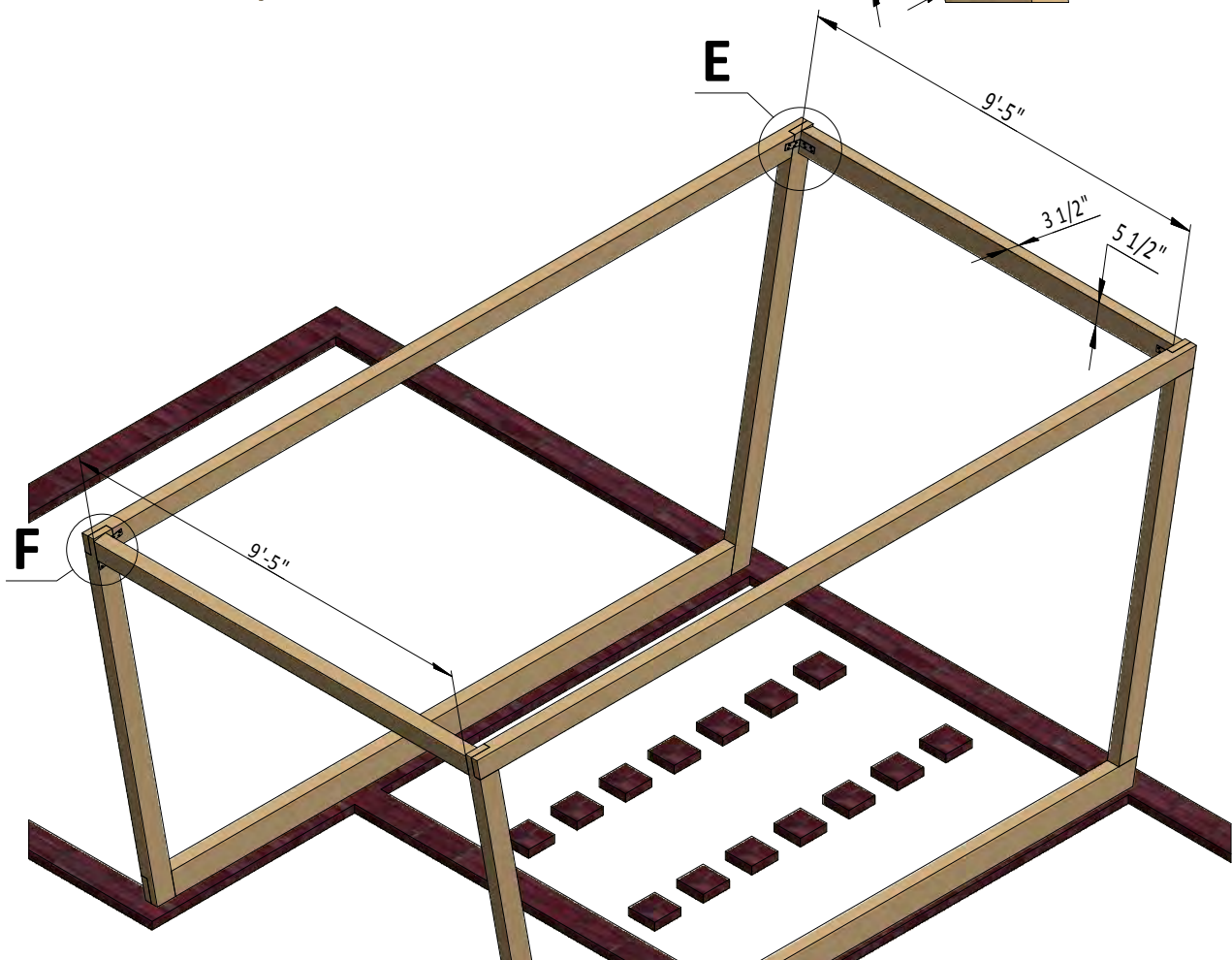
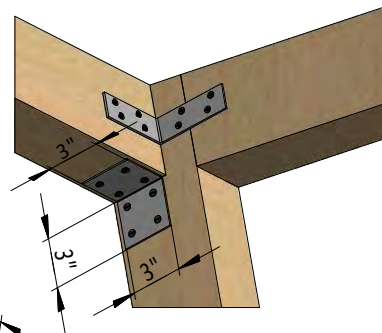

STEP 3

Framing The Floor

3.1 Provide 9 joists from the pressure-treated lumber with cross-section 1 1/2 x 7 1/4 inch and install them into the frame according to the drawing.

3.2 Secure the joists to the bottom frame with 3x5" screws.

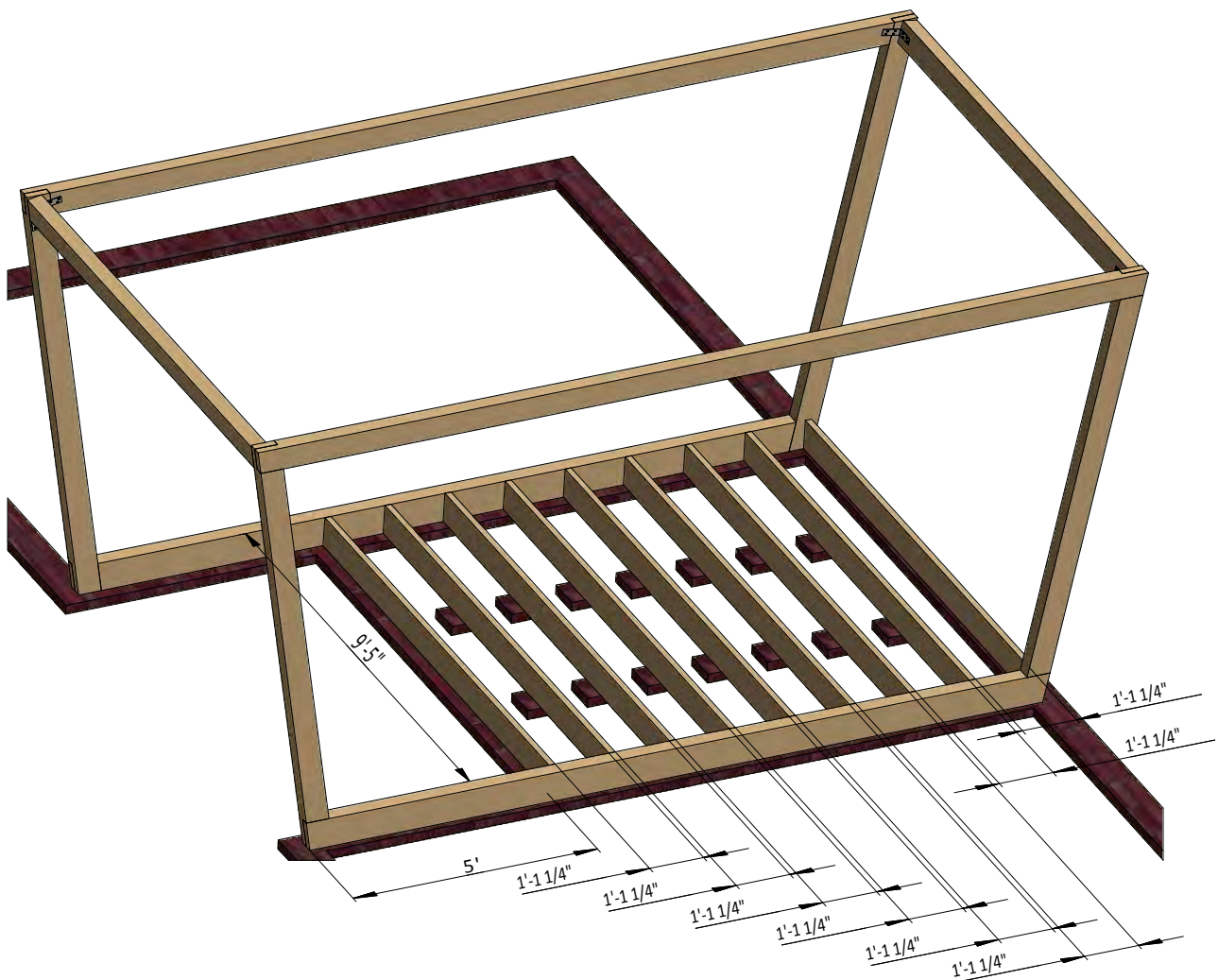

STEP 4

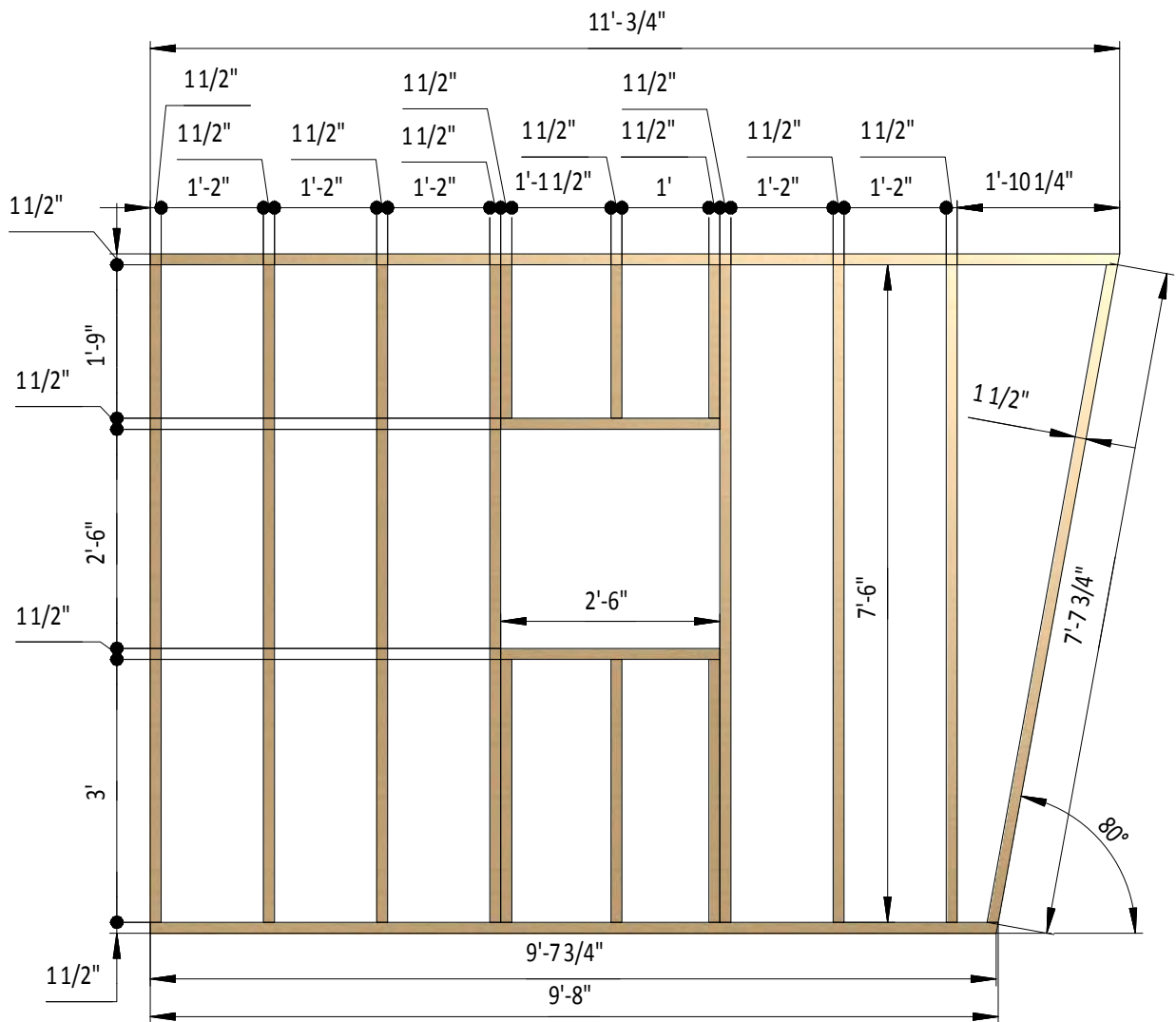

STEP 5

Assemble Back Wall Frame

5.1 Using 1 1/2 " x 3 1/2 " pressure-treated material, construct the wall frame for the back of the coop using the drawing below as a reference.

5.2 Connect the beams with 2x4" wood screws.

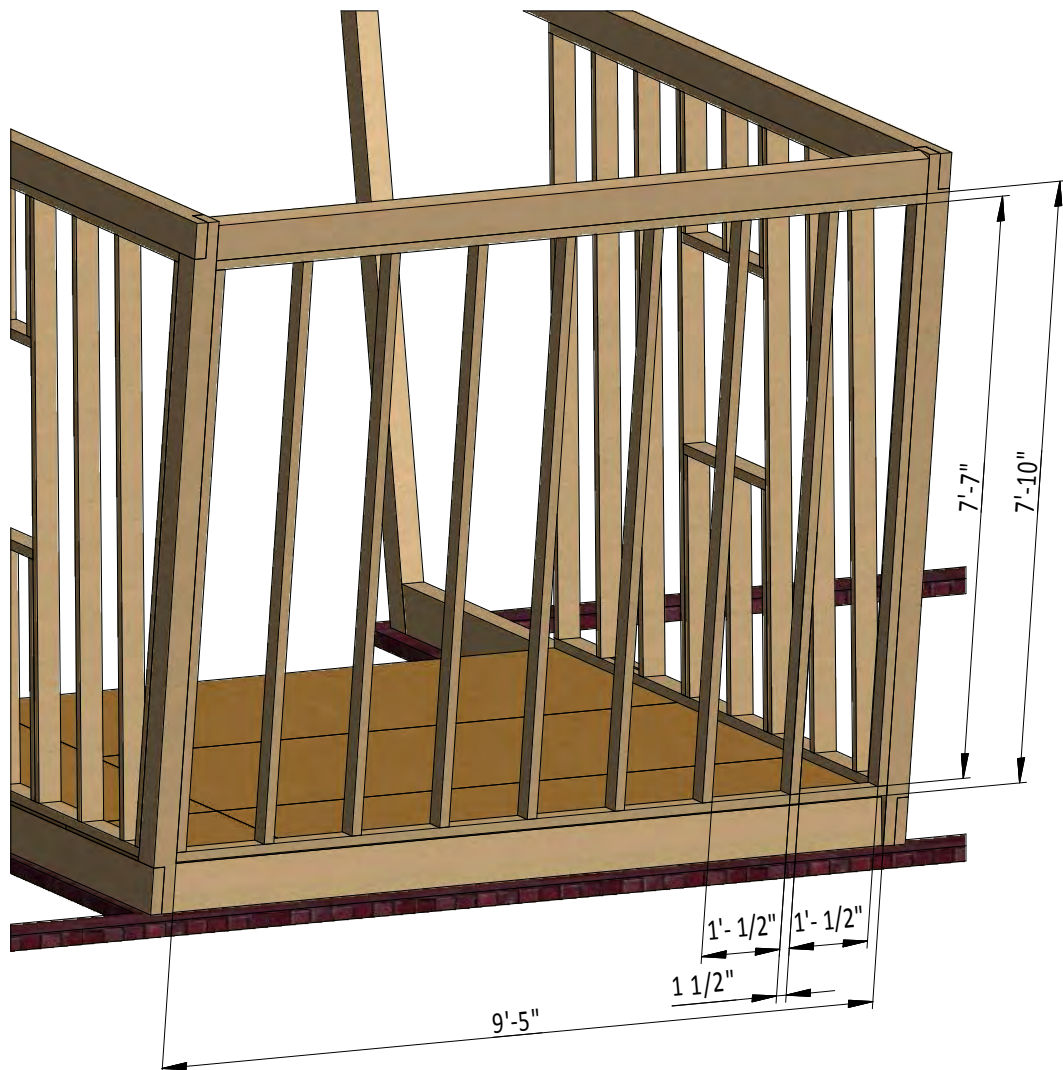

STEP 6

Assemble Front Wall Frame

6.1 Using 1 1/2 " x 3 1/2 " pressure-treated material, construct the front wall frame using the drawing below as a reference.

6.2 Connect the beams with 2x4" wood screws.

6.3 Use 3/4 " x 1 1/2 " pressure-treated material to construct the framing for the door and use the drawing as a guide.

6.4 Use 2" wood screws for constructing the frame.



STEP 7

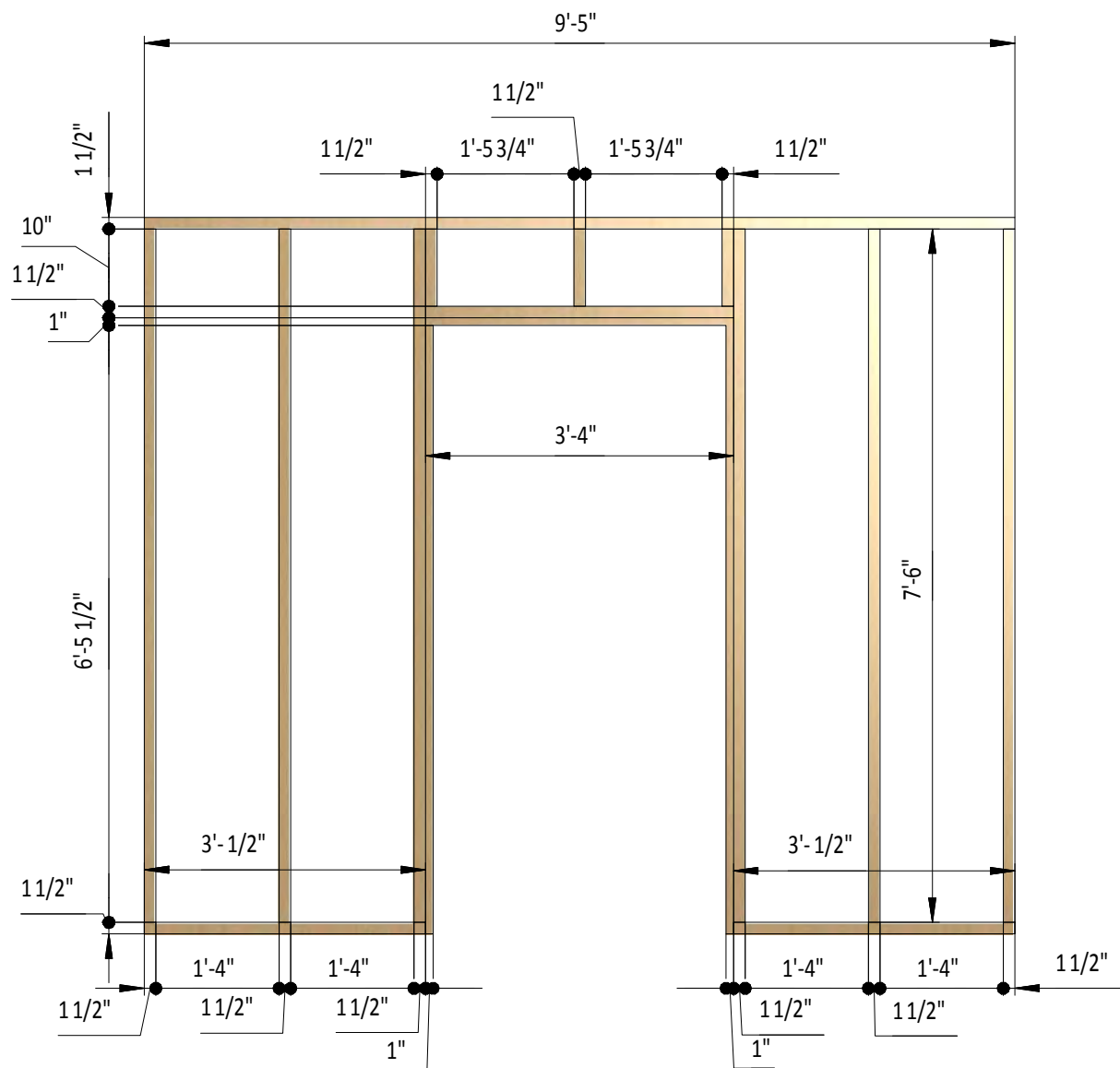

STEP 8

Assemble The Roof Frame

- 8.1 Prepare 14 rafters with cross-section $1\frac{1}{2} \times 5\frac{1}{2}$ inch (node G).
- 8.2 Prepare 5 collar ties with cross-section $1\frac{1}{2} \times 5\frac{1}{2}$ inch (node H).
- 8.3 Prepare the ridge board with cross-section $1\frac{1}{2} \times 5\frac{1}{2}$ inch.
- 8.4 Connect the beams with 2×4 " wood screws.

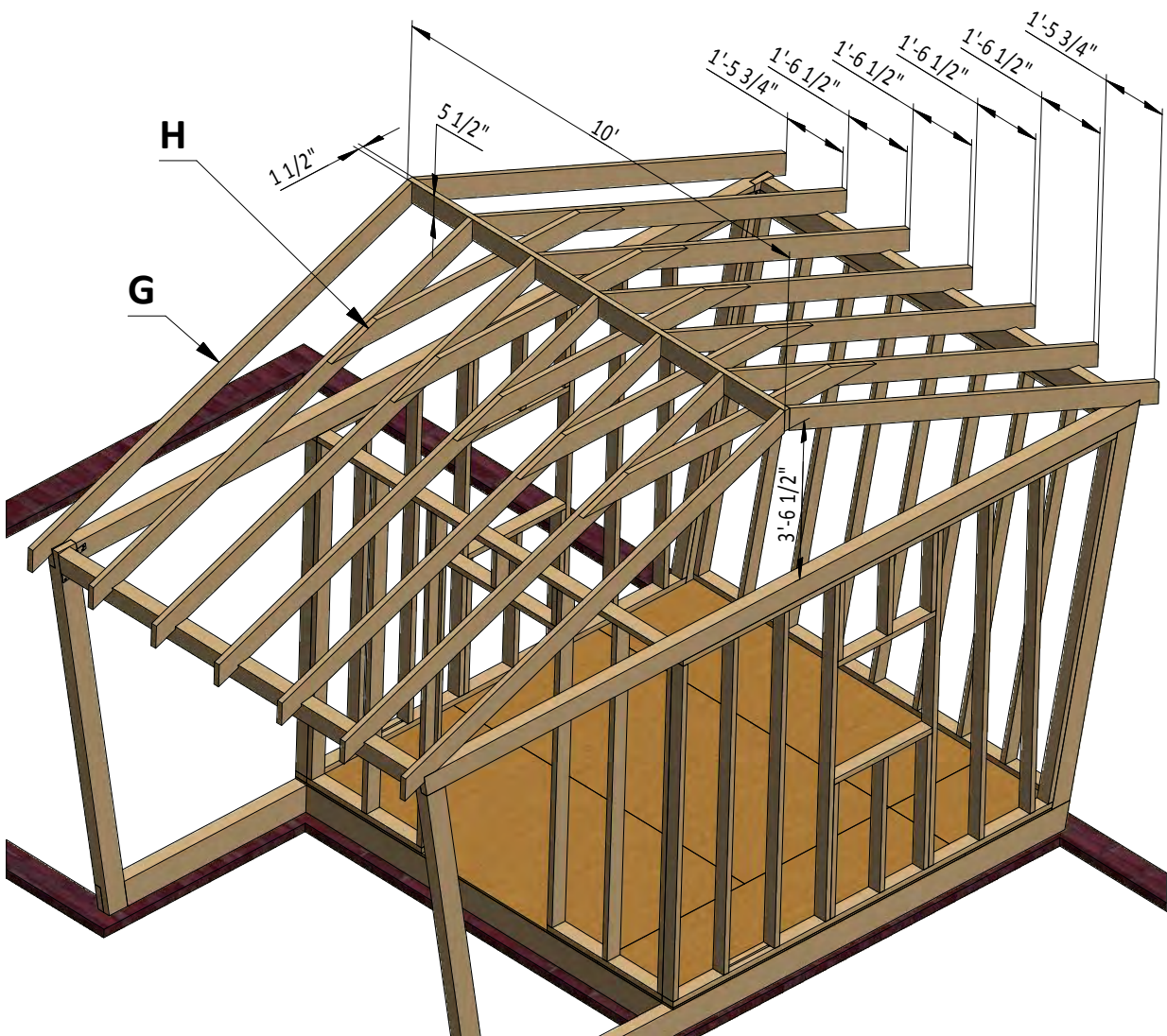

STEP 9

Window Installation for Right Wall

It is necessary to prepare 2 windows.

9.1 Using 1 1/2 " x 3/4 " pressure-treated material, cut the outer frame for the window as shown in the drawing below. Additionally, add vertical and horizontal supports using 3/4 " x 3/4 " material and cut the recesses for the window hinges.

9.2 Prepare 1/4" wire mesh for window according to the dimensions.

9.3 Make the inner frame from the pressure-treated lumber with a cross section 3/4 x 3/4 inch with 2x2" wood screws. On the inner side, it is necessary to mill the groove for glass. On the outer left side, it is necessary to mill the grooves for hinges.

9.4 Prepare and install glass into inner frame groove and fasten it by window beading from four sides. Use for this 1/2" galvanized nails.

9.5 Install hinges (4") with 3x1" wood screws and assemble the window.

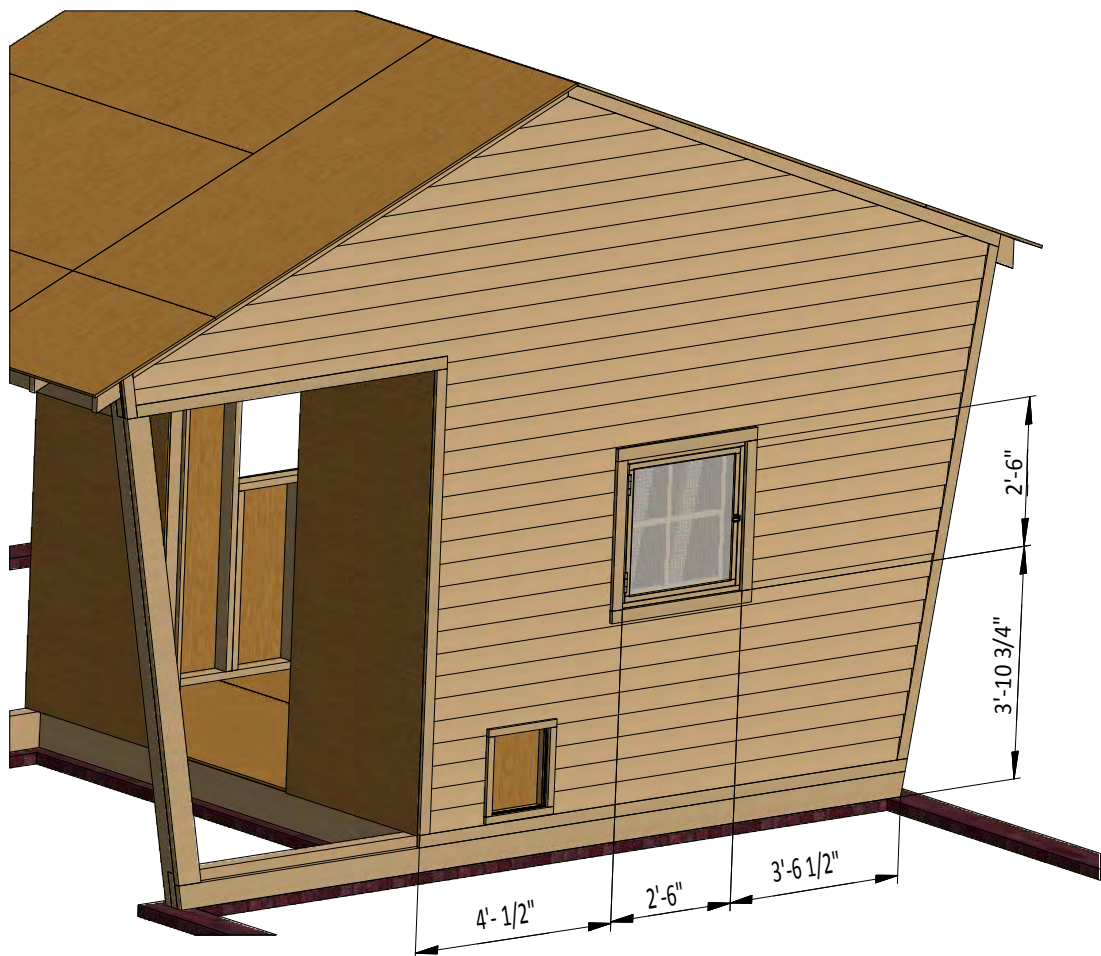

STEP 10

Assemble and Install Coop Door

10.1 Assemble the frame from the pressure-treated lumber with cross section $2\frac{1}{2} \times 1\frac{1}{2}$ " with 2×5 " wood screws according to the drawing. Prepare and install $\frac{9}{16}$ " plywood sheet.

10.2 Install door trims from the pressure-treated lumber with cross section $2\frac{1}{2} \times \frac{3}{4}$ " with 2" wood screws according to the drawing.

10.3 Prepare and install starter courser from the pressure-treated lumber with cross section $\frac{1}{4} \times \frac{3}{4}$ inch (node J).

10.4 Prepare the $\frac{1}{2} \times 6$ inch wood siding boards in the required amount according to the drawing.

10.5 Assemble siding shields with 2" galvanized nails (node J).

10.6 Install three 6" door hinges using 2×1 " wood screws. Finish the door installation by attaching 4" surface bolt and 6" door pull (see figures K,L).

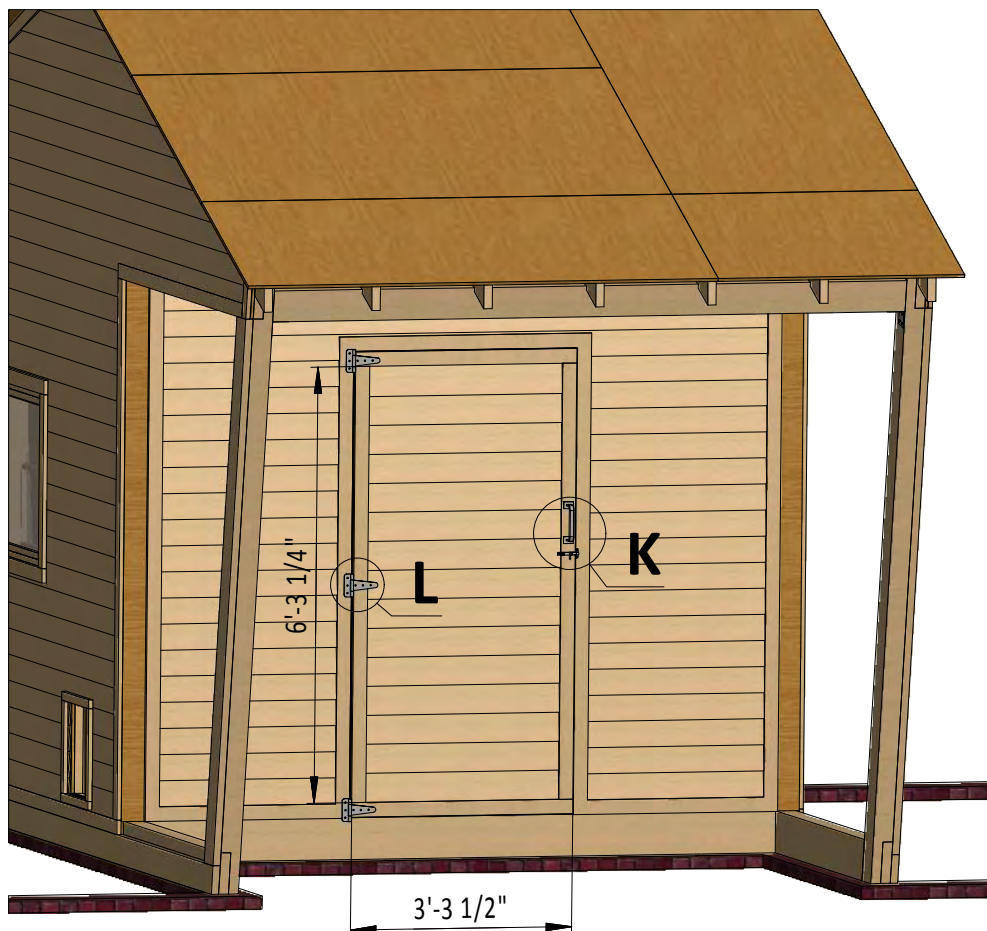

STEP 11

Installing Corrugated Roofing

11.1 To cover the roof will need 250 ft² of corrugated roof panel.

11.2 Fasten the panels with 1 1/2" sheet metal screw with neoprene washer.

11.3 Prepare and install two metal roof ridge caps according to the drawing.

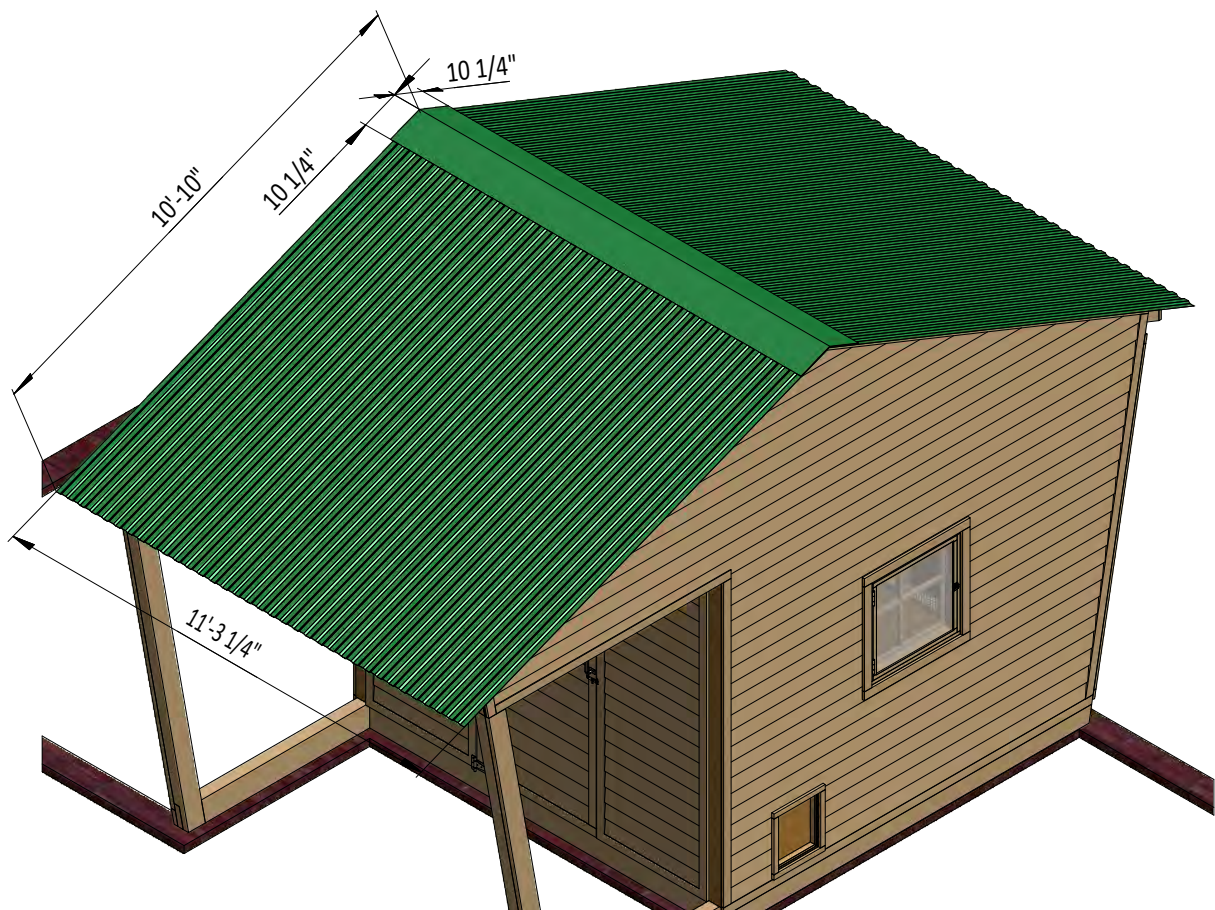

STEP 12

Aviary Front and Back Wall Stud Assembly

12.1 Prepare 4 studs with cross-section $1\frac{1}{2} \times 3\frac{1}{2}$ inch.

12.2 Connect the studs to rafter supports with 4x3" wood screws (node **U**).

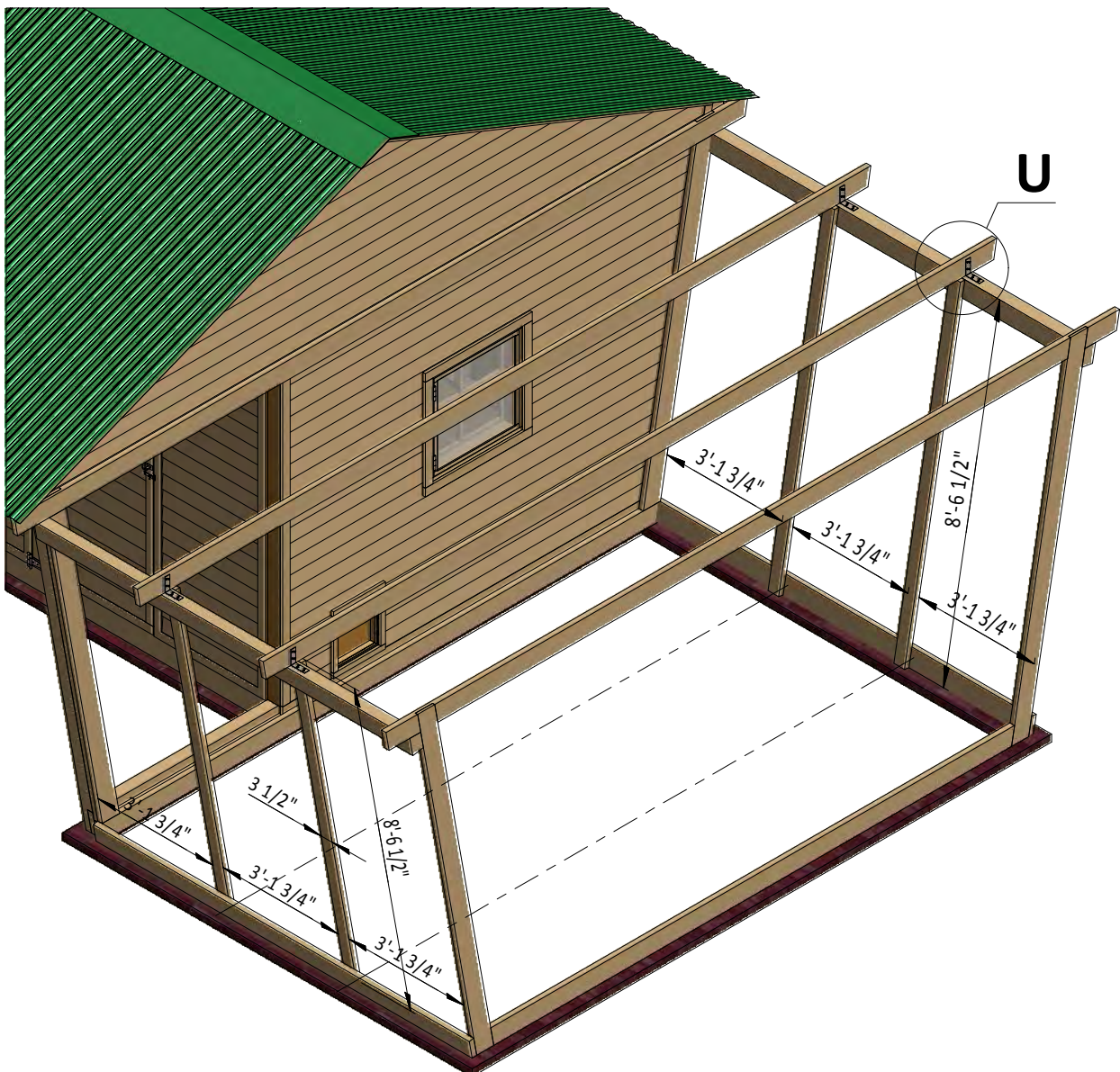

STEP 13

Aviary Door Assembly and Installation

13.1 Assemble the frame from the pressure-treated lumber with cross section $2\frac{1}{2} \times 2\frac{1}{2}$ " with 2x5" wood screws according to the drawing.

13.2 Prepare $\frac{1}{4}$ " wire mesh in the required quantity and install it on the inner side of the frame with the help of industrial stapler.

13.4 Install three 6" door hinges using 6x2" wood screws. Finish the door installation by attaching 4" surface bolt and 6" door pull (see figures X, W).

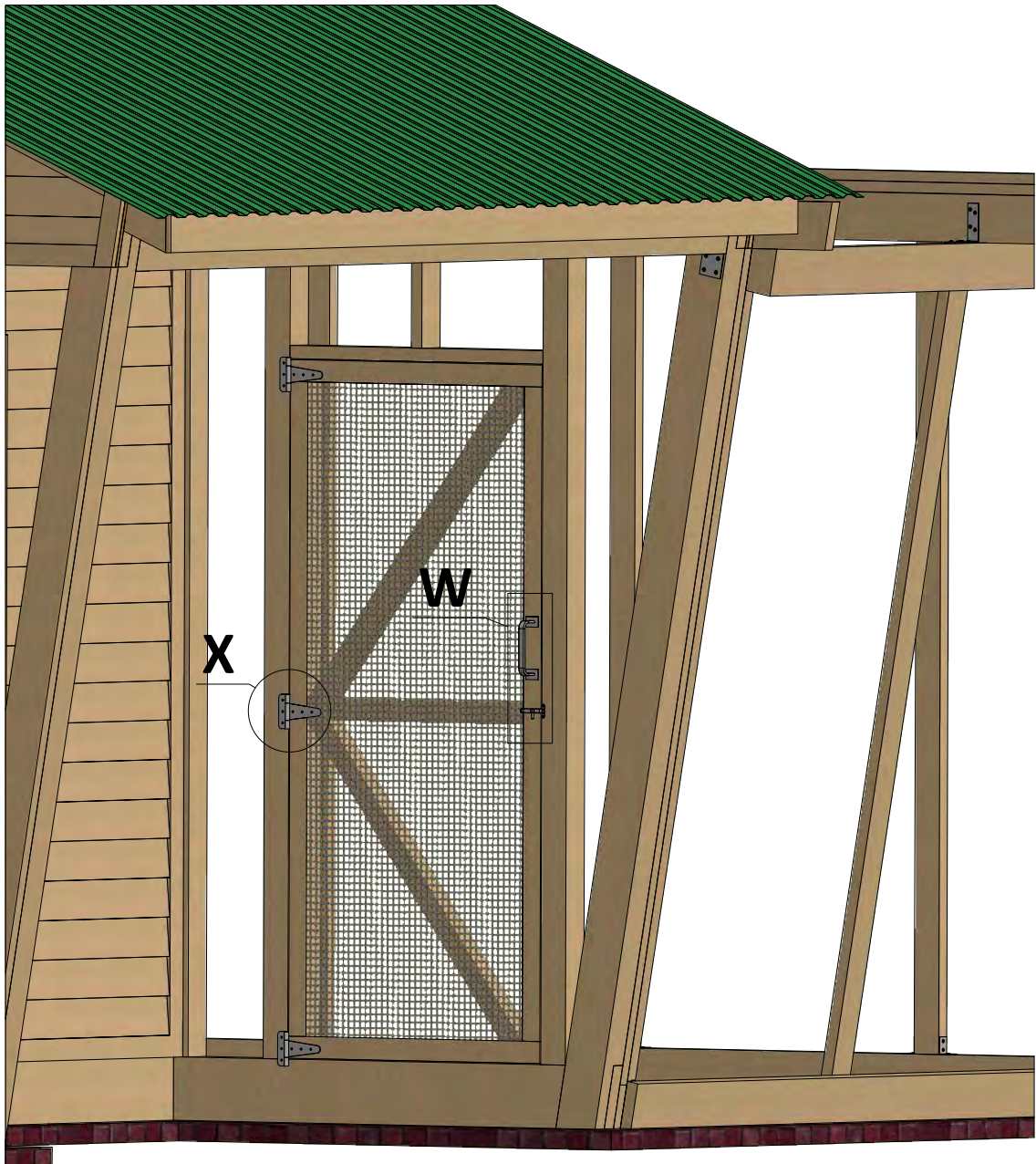

STEP 14

Building the Aviary's Side Wall Frames / Left Side

14.1 Repeat steps 27-34 to assemble left side aviary.

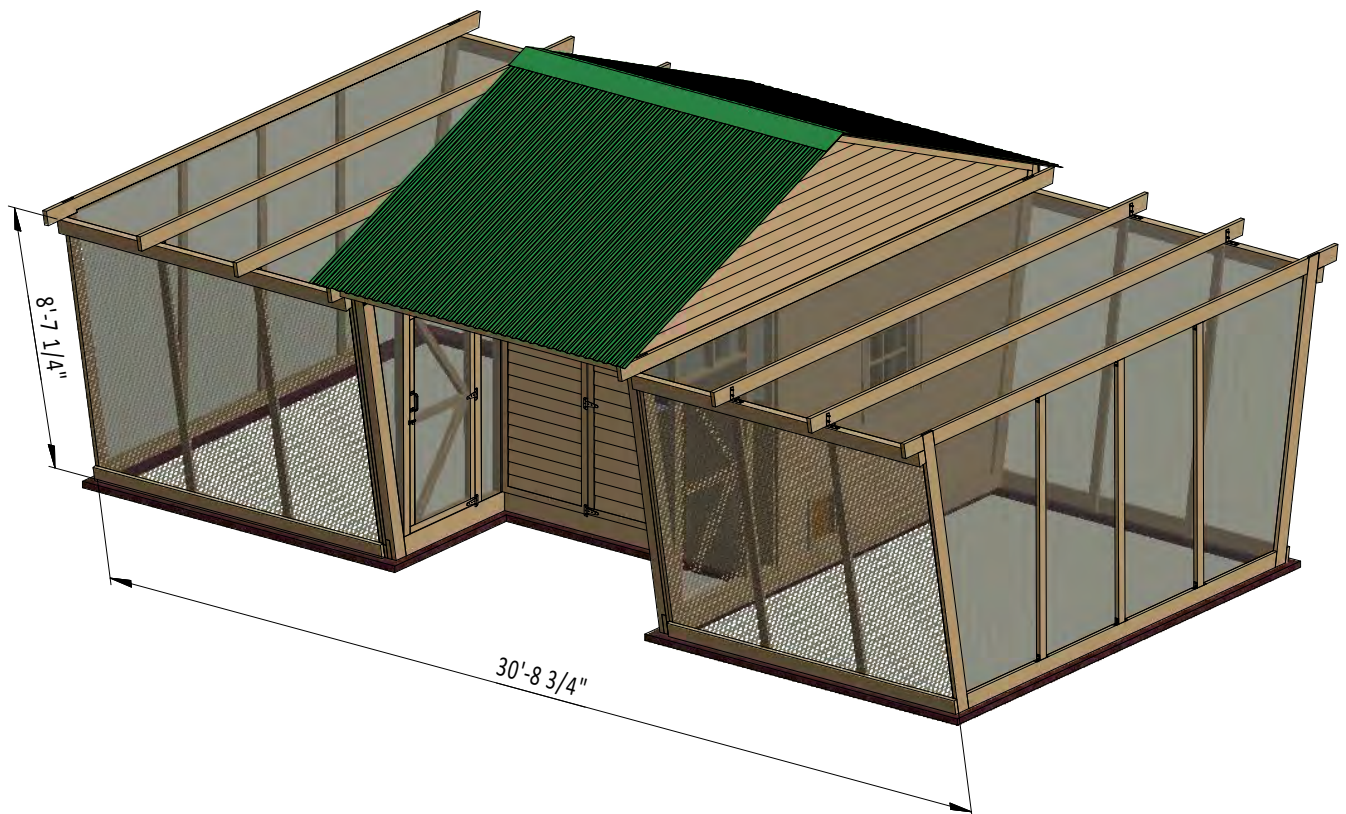

STEP 15

Final touches

Now that your coop is all done, you are ready to decorate it any way you want using your favorite paint, stain, or preservative.



Free vs. Premium Plan: What's the Difference?

We offer both free and premium versions of our detailed shed plans, designed to fit your needs and budget. Check out the table below to see the key differences and choose the plan that's right for you:

Features	Free Plan	Premium Plan
Steps Count	15	31
Illustrations per Step	Limited	Every Step
Print Ready Format	X	✓
Step-by-Step Instructions	Basic	Comprehensive
Full Materials & Cutting List	X	✓
Additional Illustrations	X	✓
Additional Blueprints	X	✓
Tools List	X	✓
Fastening Elements List	X	✓
Technical Support	X	✓

[Try Premium Risk-Free](#)

60-day refund policy with no questions asked.



For more great **HOW-TO** plans please visit: <https://craft.camp>

Copyright

The text and illustrations that appear here are the exclusive property of craft.camp and are protected by federal copyright laws. The duplication, sale or distribution of any portion of these plans without prior written consent from the original designer will be subject to the appropriate penalties for copyright infringement. Sharing this plan on the web is only permitted with an indicated original source: <https://craft.camp>